



HOW TO FILE VAT RETURN IN FORM 232 AND CST RETURN

Guide for preparation of annexures

Contents.....

1.	General Instructions.....	2
2.	Steps for Filing of Return.....	3
3.	How to prepare annexure template.....	4
4.	Sales annexure.....	8
5.	Guidelines to key in sales invoices in Sales Annexure.....	9
6.	Sales annexure for Form 232.....	11
7.	Purchase annexure (for all returns).....	13
8.	Guidelines to key in purchase invoices in Purchase annexure.....	16
9.	Transactions codes and description of transactions in purchase annexure.....	18
10.	Validate & Preview return.....	46

General Instructions

- Furtherance to the ease of doing business initiative of Government of Maharashtra, a new hassle-free e-filing return process is brought forth.
- Pursuant to the above, new template of annexures and returns in Form 231, Form 232, Form 233, Form 234, Form 235 and CST Form III (E) have been introduced in place of old annexures J1, J2 and respective old return forms.
- All Dealers are required to file Sales-Purchase annexures before submission of return. (Form 232 filers, composition dealers with entire turnover under composition are required to file purchase annexure only. They need not file Sales annexure,).
- On or before the prescribed date, dealer has to submit return online along with payment of taxes due as per return.
- Dealers can also make advance payment before online filing of return.
- Prescribed due date for filing of return is 21st day of the succeeding month.
- Single annexure template shall be used for filing of all type of returns [231, 232, 233, 234 and 235] under MVAT Act and CST Act.

Steps for Filing of Return

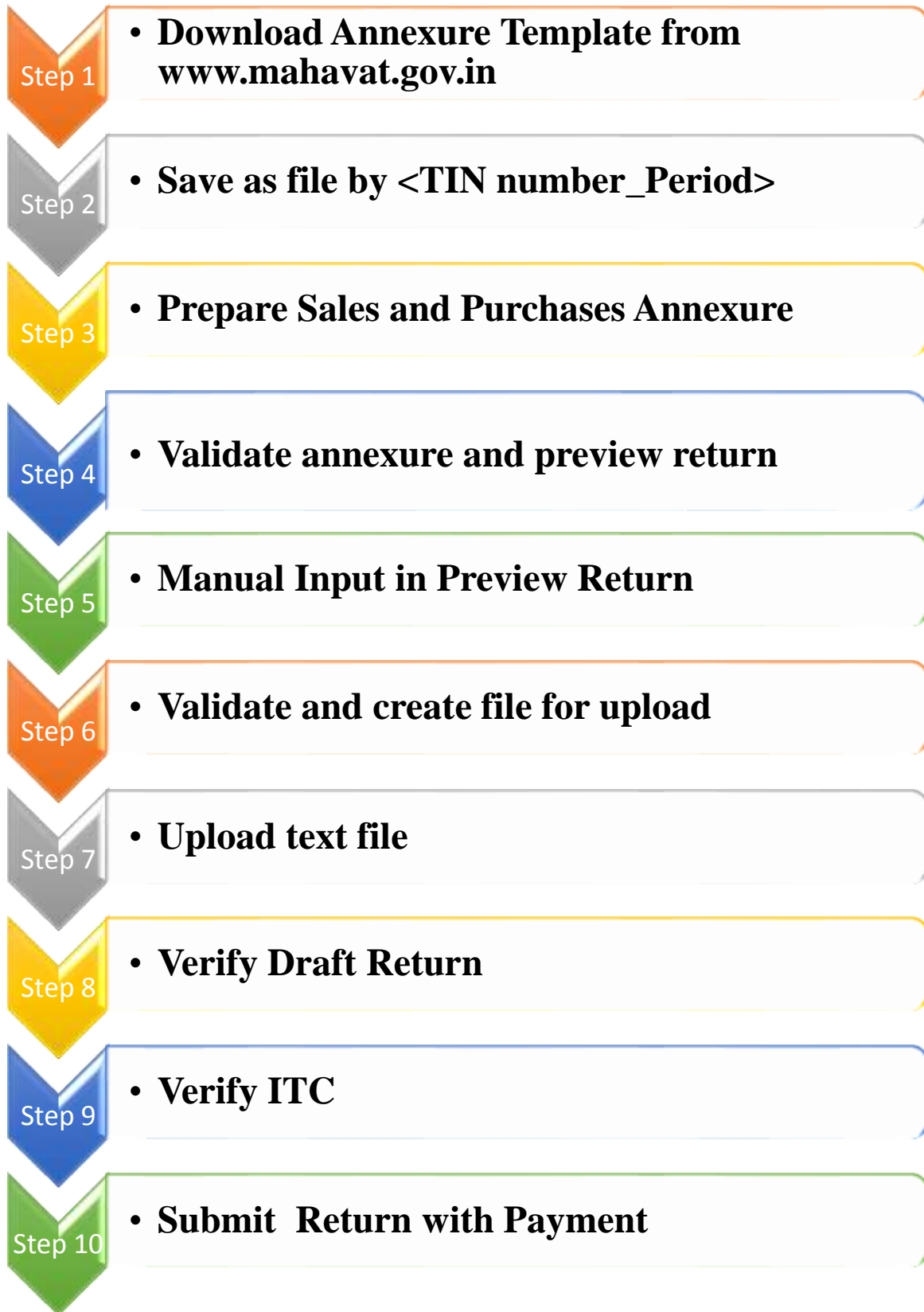

HOW TO PREPARE ANNEXURE TEMPLATE

STEP 1: Download Sales and Purchases Annexure Template

- ✓ Visit MSTD website www.mahavat.gov.in
- ✓ Go to “Dealer Services” tab and select “New Automation”
- ✓ Click on “Return”
- ✓ You will be redirected to “Home page”
- ✓ Go to “Download” tab and select “Return”
- ✓ Click on “Template”
- ✓ Download Annexure template on your desktop/personal computer and save
- ✓ Single annexure can be used for filing of all type of returns under MVAT Act and CST Act for same periodicity.

STEP 1: Save the file as <TIN number Period>

STEP 3: Prepare Sales and Purchases Annexure

- ✓ On the basis of Sales register, Purchase register and relevant books of account, prepare Sales and Purchase annexure
- ✓ You can also copy and paste special the data from your sales and purchase register to sales and purchase annexure respectively.
- ✓ In the annexure- upto row 28 - the requisite validations, comments, formulas, help, return list, transaction code, transaction descriptions have been given. Thereafter as per your requirement i.e. number of invoices to be entered in annexure, select the 28th row and drag down for additional rows.

➤ HEADER

- ✓ Dealer has to fill up “HEADER” sheet first.
- ✓ All fields are mandatory in the header sheet.

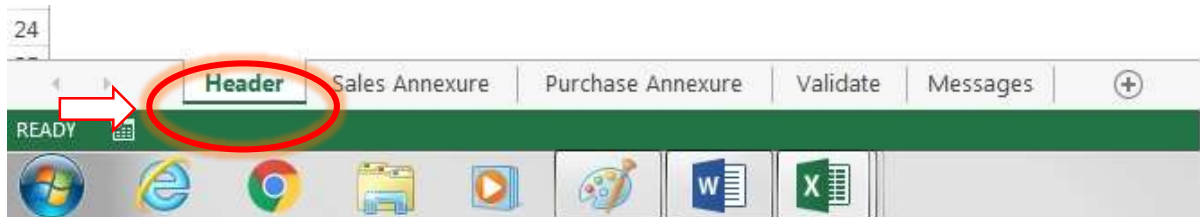

- ✓ Enter TIN and Name of the dealer in requisite fields.

	B	C	D	E
4	HEADER			
5	M.V.A.T. R.C. No.	Enter "TIN" here with suffix "V"	CST. R.C. No.	Enter "TIN" here with suffix "C"
6	Name of Dealer	Enter "NAME" of the dealer here		
7	Return Type		Return Forms to be Filed	
8	Financial Year		Return Period	
9	Whether First Return		Whether Last Return	
10	Period Covered by Return			
11	From Date			
12	To Date	0		
13	The details submitted are true and correct to the best of my knowledge and belief.			

- ✓ Select appropriate return type, whether “ORIGINAL” or “REVISED”.

	B	C	D	E
4	HEADER			
5	M.V.A.T. R.C. No.		CST. R.C. No.	
6	Name of Dealer			
7	Return Type	<div style="border: 1px solid red; border-radius: 50%; padding: 5px; display: inline-block;"> ORIGINAL REVISED u/s 20(4)(a) REVISED u/s 20(4)(b) REVISED u/s 20(4)(c) </div>	Return Forms to be Filed	
8	Financial Year		Return Period	
9	Whether First Return		Whether Last Return	
10	Period Covered by Return			
11	From Date			
12	To Date	0		0
13	The details submitted are true and correct to the best of my knowledge and belief.			
14	Name Of Authorised Person*			
15	Designation*			
16	Mobile No*			
17	E_mail_id*			

- ✓ Select appropriate combination of return forms to be filed.

	B	C	D	E
4	HEADER			
5	M.V.A.T. R.C. No.		CST. R.C. No.	
6	Name of Dealer			
7	Return Type		Return Forms to be Filed	
8	Financial Year		Return Period	<div style="border: 1px solid red; border-radius: 50%; padding: 5px; display: inline-block;"> 231_CST 233_CST 234_CST 235_CST 231_234 233_234 233_235 231_234_CST </div>
9	Whether First Return		Whether Last Return	
10	Period Covered by Return			
11	From Date			
12	To Date	0		
13	The details submitted are true and correct to the best of my knowledge and belief.			
14	Name Of Authorised Person*			
15	Designation*			
16	Mobile No*			
17	E_mail_id*			

- ✓ Please note only the following combination of return types are permissible as per the provisions of law:-

1. 231 and 234
2. 233 and 234
3. 233 and 235
4. CST return with all MVAT forms.

- ✓ Select appropriate “Financial Year” and “Return Period” for which return is to be filed.

	B	C	D	E
4	HEADER			
5	M.V.A.T. R.C. No.		CST. R.C. No.	
6	Name of Dealer			
7	Return Type		Return Forms to be Filed	
8	Financial Year	2016-2017	Return Period	
9	Whether First Return		Whether Last Return	
10	Period Covered by Return			
11	From Date			
12	To Date			
13	The details submitted are true and correct to the best of my knowledge and belief.			
14	Name Of Authorised Person*			
15	Designation*			
16	Mobile No*			
17	E_mail_id*			
18				

Dropdown menu for Return Period:

- 2016 April
- 2016 May
- 2016 June
- 2016 July
- 2016 August
- 2016 September
- 2016 October
- 2016 November

- ✓ Select “Whether First Return” in case of first return of new registered dealer.
- ✓ If selected “Yes” then the field “From Date” can be modified as per the period covered by return.

	B	C	D	E
4	HEADER			
5	M.V.A.T. R.C. No.		CST. R.C. No.	
6	Name of Dealer			
7	Return Type		Return Forms to be Filed	
8	Financial Year		Return Period	
9	Whether First Return		Whether Last Return	
10		YES NO	Return	
11	From Date			
12	To Date	0		0
13	The details submitted are true and correct to the best of my knowledge and belief.			
14	Name Of Authorised Person*			
15	Designation*			
16	Mobile No*			
17	E_mail_id*			
18				

- ✓ Select “Whether Last Return” in case of last return of registration cancelled dealer.
- ✓ If selected “Yes” then the field “To Date” can be modified as per the period covered by return.

	B	C	D	E
4	HEADER			
5	M.V.A.T. R.C. No.		CST. R.C. No.	
6	Name of Dealer			
7	Return Type		Return Forms to be Filed	
8	Financial Year		Return Period	
9	Whether First Return		Whether Last Return	
10	Period Covered by Return			
11	From Date			
12	To Date	0		0
13	The details submitted are true and correct to the best of my knowledge and belief.			
14	Name Of Authorised Person*			
15	Designation*			
16	Mobile No*			
17	E_mail_id*			

- ✓ Enter details of the “Authorised Person” with “Designation”, “Mobile No.” and “E-mail id”.

	B	C	D	E
4	HEADER			
5	M.V.A.T. R.C. No.		CST. R.C. No.	
6	Name of Dealer			
7	Return Type		Return Forms to be Filed	
8	Financial Year		Return Period	
9	Whether First Return		Whether Last Return	
10	Period Covered by Return			
11	From Date			
12	To Date	0		0
13	The details submitted are true and correct to the best of my knowledge and belief.			
14	Name Of Authorised Person*			
15	Designation*			
16	Mobile No*			
17	E_mail_id*			
18				

➤ SALES ANNEXURE

- ✓ After “HEADER” sheet, Dealer has to fill up the “Sales Annexure”.

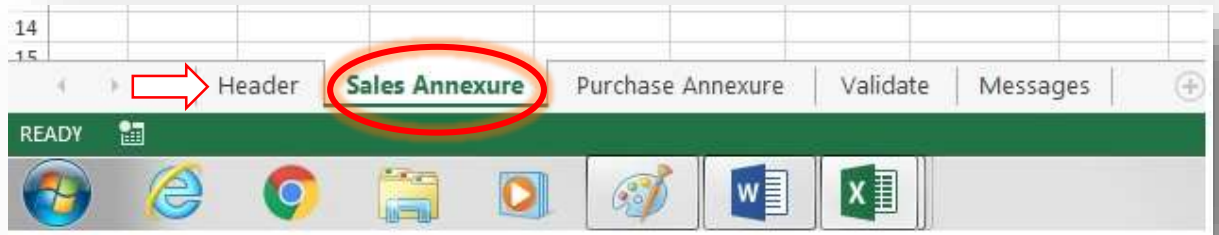

- ✓ Sales annexure is to be prepared for all types of return under VAT [except 232] and CST.
- ✓ Sales annexure is to be prepared in the format shown below.
- ✓ Every invoice is to be entered across one row irrespective of various tax rates or different types of sales.
- ✓ Permutation and combination of various type of sales are allowed in a single invoice, such as-
 - Taxable sales (including works contract composition sales)
 - Inclusive of tax sales
 - Tax free sales
 - Exempted sales u/s 41 and 8
 - Labour charges
 - Other charges

Transactionwise Sales Details																	
Gross Total			0	0	0	0	0	0	0	0	0	0	0	0			
Line Item	Invoice No.	Date of Sale Invoice	TIN of Purchaser (If Any)	Taxable Value OR Value of Composition u/s 42(3), (3A), (4)		Value of Inclusive of Tax Rs.	Value of Composition u/s 41 (1), (2) Rs.	Tax Free Sales Rs.	Exempted Sales u/s 41 & 8 Rs.	Labour Charges Rs.	Other Charges (Rs)	Gross Total (Rs.)	Action	Return Form Number	Transaction Code	Discription of Transaction type	
				Net Rs.	TAX (If any) Rs.												

Transaction codes are assigned to the nature of transactions, such as-

- 100 - for sales to TIN holder (**RD**)
- 200 - for sales to Non-TIN holder (**URD**)
- 300 - for Branch Transfer/Consignment sales
- 800 - for deduction u/s 3(2) i.e. turnover of sales before crossing threshold limit.
- 600 - for goods return (applicable in case of transactions under codes 100, 200 and 800)
- 700 - for credit notes (applicable in case of transactions under codes 100, 200 and 800)
- 680 - for goods return (applicable in case of transactions under code 300)
- 780 - for credit notes (applicable in case of transactions under code 300)

The above transaction codes are common to the return forms 231, 233, 234, 235 and CST III (E).

Note- for return form 232 Sales annexure is not required to file.

Guidelines to key in sales invoices in Sales Annexure

Column	Field Name	Guidelines
A	Serial Number	The numbering should be in sequence starting with serial number 1.
B	Sales Invoice Number	<ul style="list-style-type: none"> • Enter the serial number of the Sales Invoice issued or any document reference number. • Alpha Numeric, special characters (-) and (/) are allowed. • In case sales to non-TIN holder and aggregate amount of sales is shown then invoice number field shall be blank. • Credit note for rate difference or discount or assets sales is issued then credit note number.
C	Date of Sales Invoice	<ul style="list-style-type: none"> • Date of Sales Invoice should be of the period mentioned in the “Header” of the annexure. • In case of “goods return” the date should be within six months from the annexure period • In case of “credit note” previous date to the annexure period is acceptable. • No future date shall be acceptable in Sales annexure. • Date format shall be in dd/mm/yyyy format.
D	TIN of the Purchaser	Enter TIN when the goods are Purchased within State or inter-State by TIN holding dealer.
E	Net Taxable Value OR Value of Composition u/s 42(3), (3A), (4)	<ul style="list-style-type: none"> • Enter Net Value of goods, whether tax is levied or not.[except transactions of inclusive of tax, tax free, composition, exempted sales] • In case of taxable transactions, enter aggregate net value of various tax rate transactions.
F	TAX (If any)	Enter the tax levied on net value shown in column “E”.
G	Value of Inclusive of Tax	Enter the gross sales value inclusive of tax.
H	Value of Composition u/s 42 (1), (2)	Enter the Sales Value of Composition u/s 42 (1), (2)
I	Tax Free Sales	Enter the Value of Tax Free Sales

J	Exempted Sales u/s 41 & 8	Enter Sales Value of Exempted Sales u/s 41 & 8
K	Labour Charges	Enter Value of Labour Charges
L	Other Charges	Enter Value of Other Charges
M	Gross Total	Gross total of invoice
N	Action	<ul style="list-style-type: none"> • This field is for those dealers who are required to file single revised return for the year u/s 20(4)(b) and 20(4)(c). • Single annexure is to be filed for the year. • Enter invoices which are required to be deleted from the periodic annexures. • Enter “D” in this column against these invoices which are required to be deleted. • If any new transactions are added then keep this column blank.
O	Return Form Number	<ul style="list-style-type: none"> • Enter applicable Return Form Number. • Only permitted combination of return forms will be validated.
P	Transaction Code	<ul style="list-style-type: none"> • Enter Transaction codes according to Transactions types. • Permutation and combination of various type of sales in one transaction type is allowed, such as- <ul style="list-style-type: none"> ▪ Taxable sales ▪ Inclusive of tax sales ▪ Tax free sales ▪ Composition sales ▪ Exempted sales ▪ Labour charges ▪ Other charges
Q	Description of Transaction type	On selection of Transactions codes, description of Transactions will be auto populated.

- ✓ While claiming “goods return” for any invoice-
 - **Original Sales invoice number** is to be mentioned against which goods return is claimed.
 - **Date** of original sales invoice is to be mentioned.
 - **TIN** of purchaser, if any, is to be mentioned.
- ✓ While claiming credit notes of aggregate value for any period against any TIN-
 - **Credit note number** is to be mentioned in invoice number column.
 - **Date** of credit note is to be mentioned.
 - **TIN** of purchaser is to be mentioned.
- ✓ Goods return [600] or credit note claim [700] against deduction u/s 3(2) [800] is not admissible in the first return of registered period.

**SALES ANNEXURE FOR
FORM 232**

FORM 232 - No Sales Annexure.

If any Composition Dealer effects Inter-state transactions then he shall file FORM-233 with CST combination.

**PURCHASE ANNEXURE
(FOR ALL
RETURNS)**

PURCHASE ANNEXURE

- ✓ After “Sales Annexure” sheet, Dealer has to fill up “Purchase Annexure”.

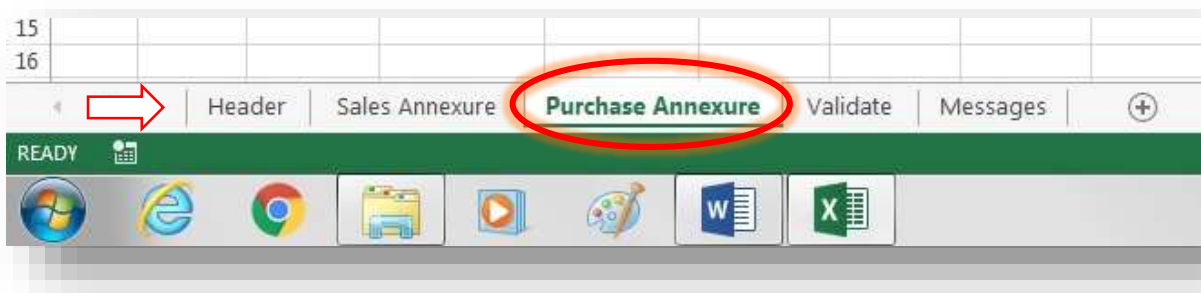

- ✓ Purchase annexure is to be prepared in following format.
- ✓ Every invoice is to be entered across one row irrespective of various tax rates or different types of purchases.

Transactionwise Purchase Details																
			Gross Total	1500	125	1625	500	500	500	500	700	5950				
Sr.No	Sales Invoice No.	Date of Sales Invoice	TIN of Seller (If Any)	Taxable Value OR Value of Composition u/s 42(3),(3A)		Value of Inclusive of Tax Rs.	Value of Composition u/s 42(1), (2), (4) Rs.	Tax Free Purchases Rs.	Exempted Purchases u/s 41 & 8 Rs.	Labour Charges Rs.	Other Charges (Rs)	Gross Total (Rs.)	Action	Return Form Number	Transaction Code	Description of Transaction type
				Net Rs.	TAX (If any) Rs.											

Transaction code are assigned to the nature of transactions, such as-

- 10 - for purchases from TIN holder (**RD**)
- 15 - for purchases from TIN holder (**RD**) **capital goods**
- 20 - for purchases Non-TIN holder (**URD**)
- 30 - for Inter-state Branch Transfer/Consignment purchases
- 35 - for within the State Branch Transfer
- 40 - for Inter-State Purchases against Form-C
- 45 - for within the State Purchases against Form-C (Purchase in transit u/s 6(2))
- 50 - for inter-State Purchases against Form-H
- 55 - for within the State Purchases against H Form
- 60 - for imports (Direct)
- 65 - for imports (High Seas)
- 70 - for inter-State Purchases without Form
- 75 - for inter-State Purchases against Form-I
- 80 - for deduction u/s 3(2), turnover of purchases before crossing threshold limit.

Goods return and debit notes-

- 90 - for goods return (applicable to 10, 15 and 80)
- 95 - for debit notes (applicable to 10, 15 and 80)
- 91 - for goods return (applicable to 20)

- 96 - for debit notes (applicable to 20)
- 31 - for goods return (applicable to 30)
- 32 - for debit notes (applicable to 30)
- 36 - for goods return (applicable to 35)
- 37 - for debit notes (applicable to 35)
- 41 - for goods Return (Interstate Purchases against Form-C) (applicable to 40)
- 42 - for debit Note (Interstate Purchases against Form-C) (applicable to 40)
- 46 - for goods Return (Within State purchases against Form-C) (applicable to 45)
- 47 - for debit Note (Within State Purchases against Form-C) (applicable to 45)
- 51 - for goods Return (Inter State Purchases against Form-H) (applicable to 50)
- 52 - for debit Note (Inter State Purchases against Form-H) (applicable to 50)
- 56 - for goods Return (Within State Purchases against Form-H) (applicable to 55)
- 57 - for debit Note (With State Purchases against Form-H) (applicable to 55)
- 61 - for goods Return (Direct Import) (applicable to 60)
- 62 - for debit Note (Direct Import) (applicable to 60)
- 66 - for goods Return (High Seas) (applicable to 65)
- 67 - for debit Note (High Seas) (applicable to 65)
- 71 - for goods Return (Inter-State Purchases without Form) (applicable to 70)
- 72 - for debit Note (Inter-State Purchases without Form) (applicable to 70)
- 76 - for goods Return (Inter-State Purchases against Form-I) (applicable to 70)
- 77 - for debit Note (Inter-State Purchases against Form-I) (applicable to 70)

These transaction codes are common across the return form 231, 232, 233, 234, 235.

Guidelines to key in purchase invoices in Purchase Annexure

Column	Field Name	Description
A	Serial Number	The numbering should be in sequence starting with serial number 1.
B	Sales Invoice Number	<ul style="list-style-type: none"> • Enter the serial number of the Sales Invoice issued by your seller. • Alpha Numeric, special characters (–) and (/) are allowed. • In case Purchases from non-TIN holder and aggregate amount of Purchases is shown then invoice number field shall be blank. • Debit note for rate difference or discount or assets purchase is issued then debit note number.
C	Date of Sales Invoice	<ul style="list-style-type: none"> • Date of Invoice may be of the period mentioned in the “Header” of the annexure or of any previous period accounted for in the current period. • In case of “Goods return” the date should be within six months from the annexure period • In case of “Credit note” previous date to the annexure period is acceptable. • No future date will be acceptable in Purchase annexure. • Date format shall be in dd/mm/yyyy format.
D	TIN of the Seller	Enter the TIN when the goods are Purchased from TIN holding dealer from within the State or inter-State.
E	Net Taxable Value OR Value of Composition u/s 42(3), (3A), (4)	<ul style="list-style-type: none"> • Enter Net Value of goods, whether tax is levied or not.[except transactions of inclusive of tax, tax free, composition, exempted purchases]. • In case of taxable transactions enter aggregate net value of various tax rate transactions.
F	TAX (If any)	Enter tax amount levied on net value shown in column “E”.
G	Value of Inclusive of Tax	Enter Purchase Value of inclusive of tax.
H	Value of Composition u/s 42 (1), (2)	Enter Purchase Value of Composition u/s 42 (1), (2)
I	Tax Free Purchase	Enter Value of Tax Free Purchases

J	Exempted Purchase u/s 41 & 8	Enter Purchase Value of Exempted goods u/s 41 & 8
K	Labour Charges	Enter Value of Labour Charges
L	Other Charges	Enter Value of Other Charges
M	Gross Total	Enter Gross Total of invoice
N	Action	<ul style="list-style-type: none"> • This field is for those dealers who are required to file revised return for the year u/s 20(4)(b) or 20(4)(c) for the year. • Single annexure is to be filed for the year. • Enter invoices which are to be deleted from periodic annexures. • Enter “D” against this column against those invoices which are to be deleted. • If any new transactions are to be added then keep this column blank.
O	Return Form Number	<ul style="list-style-type: none"> • Enter Return form number. • Only permitted combination of return forms will be validated.
P	Transaction Code	Enter Transaction codes according to Transactions types.
Q	Description of Transaction type	On selection of Transactions codes description of Transactions will be displayed.

- ✓ While claiming goods return or credit note for any invoice-
 - Original Sales invoice number is to be mentioned.
 - Date of original sales invoice is to be mentioned.
 - TIN of seller, if any, is to be mentioned.

- ✓ While claiming debit notes of aggregate value for any period against any TIN-
 - **Debit note number** is to be mentioned in invoice number column.
 - **Date** of credit note is to be mentioned.
 - **TIN** of seller is to be mentioned.

TRANSACTIONS CODES AND DESCRIPTION OF TRANSACTIONS IN PURCHASE ANNEXURE

FORMS 231, 232, 233, 234, 235

1. Purchase Transactions from TIN holder (Goods [10] and Capital Assets [15])-

- ✓ For the purposes of forms 231, 232, 233, 234 and 235 the primary transaction codes in Purchases annexure for purchases from TIN holder are 10 for goods and 15 for capital assets. Description for codes is as follows-

Transaction Code	Description of Transaction
10	Within State Purchases from TIN Holder
15	Within State Purchases from TIN Holder (Capital Asset)

- ✓ Transaction code 10 is for Within State **Purchases from TIN Holder**.
- ✓ Transaction code 15 is for Within State **Purchases from TIN Holder (Capital Asset)**.
- ✓ Illustrations of invoices under transaction code 10 and 15 in purchase annexure for forms 231, 232, 233, 234 and 235 are as follows.

Transactionwise Purchase Details												
1500	125	1625	500	500	500	500	700	5950				
Taxable Value OR Value of Composition u/s 42(3),(3A)		Value of Inclusive of Tax Rs.	Value of Composition u/s 42(1), (2), (4) Rs.	Tax Free Purchases Rs.	Exempted Purchases u/s 41 & 8 Rs.	Labour Charges Rs.	Other Charges (Rs)	Gross Total (Rs.)	Action	Return Form Number	Transaction Code	Description of Transaction type
Net Rs.	TAX (If any) Rs.											
100.00	5.00	105.00	100.00	100.00	100.00	100.00	100.00	710.00		231	10	Within the State Purchases from RD
100.00	5.00	105.00	100.00	100.00	100.00	100.00	100.00	710.00		232	10	Within the State Purchases from RD
100.00	5.00	105.00	100.00	100.00	100.00	100.00	100.00	710.00		233	10	Within the State Purchases from RD
100.00	5.00	105.00	100.00	100.00	100.00	100.00	100.00	710.00		234	10	Within the State Purchases from RD
100.00	5.00	105.00	100.00	100.00	100.00	100.00	100.00	710.00		235	10	Within the State Purchases from RD

Transactionwise Purchase Details												
1500	125	1625	500	500	500	500	700	5950				
Taxable Value OR Value of Composition u/s 42(3),(3A)	TAX (if any) Rs.	Value of Inclusive of Tax Rs.	Value of Composition u/s 42(1), (2), (4) Rs.	Tax Free Purchases Rs.	Exempted Purchases u/s 41 & 8 Rs.	Labour Charges Rs.	Other Charges (Rs)	Gross Total (Rs.)	Action	Return Form Number	Transaction Code	Description of Transaction type
100.00	5.00	105.00	100.00	100.00	100.00	100.00	100.00	710.00		231	15	Within the State Purchases from RD (Capital Asset)
100.00	5.00	105.00	100.00	100.00	100.00	100.00	100.00	710.00		232	15	Within the State Purchases from RD (Capital Asset)
100.00	5.00	105.00	100.00	100.00	100.00	100.00	100.00	710.00		233	15	Within the State Purchases from RD (Capital Asset)
100.00	5.00	105.00	100.00	100.00	100.00	100.00	100.00	710.00		234	15	Within the State Purchases from RD (Capital Asset)
100.00	5.00	105.00	100.00	100.00	100.00	100.00	100.00	710.00		235	15	Within the State Purchases from RD (Capital Asset)

Shows blocked field, data shall not be validated.

Goods return [90] and debit notes [95] for Purchases from TIN holder (Goods [10] or Capital Assets [15])-

- ✓ For the purposes of forms 231, 232, 233, 234 and 235 and transaction 10 or 15 the transaction codes in purchase annexure for goods return is 90 and for debit note (rate difference, discount) is 95. Description for codes is as follows-

Transaction Code	Description of Transaction
90	Purchase Goods Return for Transaction Types 10, 15.
95	Purchase Debit Note for Transaction Types 10, 15.

- ✓ Illustrations of invoices under transaction codes 90 and 95 in purchase annexure for forms 231, 232, 233, 234 and 235 are as follows.

Transactionwise Purchase Details												
1500	125	1625	500	500	500	500	700	5950				
Taxable Value OR Value of Composition u/s 42(3),(3A)	TAX (if any) Rs.	Value of Inclusive of Tax Rs.	Value of Composition u/s 42(1), (2), (4) Rs.	Tax Free Purchases Rs.	Exempted Purchases u/s 41 & 8 Rs.	Labour Charges Rs.	Other Charges (Rs)	Gross Total (Rs.)	Action	Return Form Number	Transaction Code	Description of Transaction type
100.00	5.00	105.00	100.00	100.00	100.00	100.00	100.00	710.00		231	90	Purchase Good Return for Tr. Type 10, 15, 80
100.00	5.00	105.00	100.00	100.00	100.00	100.00	100.00	710.00		232	90	Purchase Good Return for Tr. Type 10, 15, 80
100.00	5.00	105.00	100.00	100.00	100.00	100.00	100.00	710.00		233	90	Purchase Good Return for Tr. Type 10, 15, 80
100.00	5.00	105.00	100.00	100.00	100.00	100.00	100.00	710.00		234	90	Purchase Good Return for Tr. Type 10, 15, 80
100.00	5.00	105.00	100.00	100.00	100.00	100.00	100.00	710.00		235	90	Purchase Good Return for Tr. Type 10, 15, 80

Transactionwise Purchase Details												
1500	125	1625	500	500	500	500	700	5950				
Taxable Value OR Value of Composition u/s 42(3),(3A)		Value of Inclusive of Tax Rs.	Value of Composition u/s 42(1), (2), (4) Rs.	Tax Free Purchases Rs.	Exempted Purchases u/s 41 & 8 Rs.	Labour Charges Rs.	Other Charges (Rs)	Gross Total (Rs.)	Action	Return Form Number	Transaction Code	Description of Transaction type
Net Rs.	TAX (if any) Rs.											
100.00	5.00	105.00	100.00	100.00	100.00	100.00	100.00	710.00		231	95	Purchase Debit Note for Tr. Type 10, 15, 80
100.00	5.00	105.00	100.00	100.00	100.00	100.00	100.00	710.00		232	95	Purchase Debit Note for Tr. Type 10, 15, 80
100.00	5.00	105.00	100.00	100.00	100.00	100.00	100.00	710.00		233	95	Purchase Debit Note for Tr. Type 10, 15, 80
100.00	5.00	105.00	100.00	100.00	100.00	100.00	100.00	710.00		234	95	Purchase Debit Note for Tr. Type 10, 15, 80
100.00	5.00	105.00	100.00	100.00	100.00	100.00	100.00	710.00		235	95	Purchase Debit Note for Tr. Type 10, 15, 80

Shows blocked field, data shall not be validated.

2. Purchases within State from Non-TIN holder (URD) [20]-

- ✓ For the purposes of forms 231, 232, 233, 234 and 235 the transaction code in Purchase annexure for purchases within State from Non-TIN holder (URD) is 20. Description for code is as follows-

Transaction Code	Description of Transaction
20	Within State Purchases from Non-TIN Holder (URD)

- ✓ Transaction code 20 is for Within the State **Purchases from Non-TIN Holder**.
- ✓ Illustrations of invoices under transaction code 20 in purchase annexure for forms 231, 232, 233, 234 and 235 are as follows.

Transactionwise Purchase Details												
1500	100	1100	0	500	0	500	700	4400				
Taxable Value OR Value of Composition u/s 42(3),(3A)		Value of Inclusive of Tax Rs.	Value of Composition u/s 42(1), (2), (4) Rs.	Tax Free Purchases Rs.	Exempted Purchases u/s 41 & 8 Rs.	Labour Charges Rs.	Other Charges (Rs)	Gross Total (Rs.)	Action	Return Form Number	Transaction Code	Description of Transaction type
Net Rs.	TAX (if any) Rs.											
100.00	0.00	0.00	0.00	100.00	0.00	100.00	100.00	400.00		231	20	Within the State URD Purchases
100.00	0.00	0.00	0.00	100.00	0.00	100.00	100.00	400.00		232	20	Within the State URD Purchases
100.00	0.00	0.00	0.00	100.00	0.00	100.00	100.00	400.00		233	20	Within the State URD Purchases
100.00	0.00	0.00	0.00	100.00	0.00	100.00	100.00	400.00		234	20	Within the State URD Purchases
100.00	0.00	0.00	0.00	100.00	0.00	100.00	100.00	400.00		235	20	Within the State URD Purchases

Shows blocked field, data shall not be validated.

Goods return [91] and debit notes [96] for Purchases from Non-TIN holder (URD) [20]-

- ✓ For the purposes of forms 231, 232, 233, 234 and 235 and transaction 20, the transaction codes in purchase annexure for goods return is 91 and for debit note (rate difference, discount) is 96. Description for codes is as follows-

Transaction Code	Description of Transaction
91	Purchase Goods Return (within the State URD) for Tr. Type 20.
96	Purchase Debit Note (within the State URD) for Tr. Type 20.

- ✓ Illustrations of invoices under transaction codes 91 and 96 in purchase annexure for forms 231, 232, 233, 234 and 235 are as follows.

Transactionwise Purchase Details												
1500	100	1100	0	500	0	500	700	4400				
Taxable Value OR Value of Composition u/s 42(3),(3A)		Value of Inclusive of Tax Rs.	Value of Composition u/s 42(1), (2), (4) Rs.	Tax Free Purchases Rs.	Exempted Purchases u/s 41 & 8 Rs.	Labour Charges Rs.	Other Charges (Rs)	Gross Total (Rs.)	Action	Return Form Number	Transaction Code	Description of Transaction type
Net Rs.	TAX (If any) Rs.											
100.00	0.00	0.00	0.00	100.00	0.00	100.00	100.00	400.00		231	91	Purchase Good Return (Within the State URD) for Tr. Type 20
100.00	0.00	0.00	0.00	100.00	0.00	100.00	100.00	400.00		232	91	Purchase Good Return (Within the State URD) for Tr. Type 20
100.00	0.00	0.00	0.00	100.00	0.00	100.00	100.00	400.00		233	91	Purchase Good Return (Within the State URD) for Tr. Type 20
100.00	0.00	0.00	0.00	100.00	0.00	100.00	100.00	400.00		234	91	Purchase Good Return (Within the State URD) for Tr. Type 20
100.00	0.00	0.00	0.00	100.00	0.00	100.00	100.00	400.00		235	91	Purchase Good Return (Within the State URD) for Tr. Type 20

Transactionwise Purchase Details												
1500	100	1100	0	500	0	500	700	4400				
Taxable Value OR Value of Composition u/s 42(3),(3A)		Value of Inclusive of Tax Rs.	Value of Composition u/s 42(1), (2), (4) Rs.	Tax Free Purchases Rs.	Exempted Purchases u/s 41 & 8 Rs.	Labour Charges Rs.	Other Charges (Rs)	Gross Total (Rs.)	Action	Return Form Number	Transaction Code	Description of Transaction type
Net Rs.	TAX (If any) Rs.											
100.00	0.00	0.00	0.00	100.00	0.00	100.00	100.00	400.00		231	96	Purchase Debit Note (Within the State URD) for Tr. Type 20
100.00	0.00	0.00	0.00	100.00	0.00	100.00	100.00	400.00		232	96	Purchase Debit Note (Within the State URD) for Tr. Type 20
100.00	0.00	0.00	0.00	100.00	0.00	100.00	100.00	400.00		233	96	Purchase Debit Note (Within the State URD) for Tr. Type 20
100.00	0.00	0.00	0.00	100.00	0.00	100.00	100.00	400.00		234	96	Purchase Debit Note (Within the State URD) for Tr. Type 20
100.00	0.00	0.00	0.00	100.00	0.00	100.00	100.00	400.00		235	96	Purchase Debit Note (Within the State URD) for Tr. Type 20

 Shows blocked field, data shall not be validated.

3. Interstate Branch Transfer/Consignment Purchases [30]-

- ✓ For the purposes of forms 231, 232, 233, 234 and 235 the transaction code in Purchase annexure for Interstate Branch Transfer/Consignment Purchases is 30. Description for code is as follows-

Transaction Code	Description of Transaction
30	Interstate Branch Transfer/Consignment Purchases

- ✓ Transaction code 30 is for Interstate Branch Transfer/Consignment Purchases.
- ✓ Illustrations of invoices under transaction code 30 in purchase annexure for forms 231, 232, 233, 234 and 235 are as follows.

Transactionwise Purchase Details												
1500	100	1100	0	500	0	500	700	4400				
Taxable Value OR Value of Composition u/s 42(3),(3A)		Value of Inclusive of Tax Rs.	Value of Composition u/s 42(1), (2), (4) Rs.	Tax Free Purchases Rs.	Exempted Purchases u/s 41 & 8 Rs.	Labour Charges Rs.	Other Charges (Rs)	Gross Total (Rs.)	Action	Return Form Number	Transaction Code	Description of Transaction type
Net Rs.	TAX (If any) Rs.											
100.00	0.00	0.00	0.00	100.00	0.00	100.00	100.00	400.00		231	30	Inter-State Branch Transfer
100.00	0.00	0.00	0.00	100.00	0.00	100.00	100.00	400.00		232	30	Inter-State Branch Transfer
100.00	0.00	0.00	0.00	100.00	0.00	100.00	100.00	400.00		233	30	Inter-State Branch Transfer
100.00	0.00	0.00	0.00	100.00	0.00	100.00	100.00	400.00		234	30	Inter-State Branch Transfer
100.00	0.00	0.00	0.00	100.00	0.00	100.00	100.00	400.00		235	30	Inter-State Branch Transfer

 Shows blocked field, data shall not be validated.

Goods return [31] and debit notes [32] for interstate branch transfer/consignment purchases [30])-

- ✓ For the purposes of forms 231, 232, 233, 234 and 235 and transaction 30, the transaction codes in purchase annexure for goods return is 31 and for debit note (rate difference, discount) is 32. Description for codes is as follows-

Transaction Code	Description of Transaction
31	Purchase Goods Return (Inter-state Branch transfer) for Tr. Type 30.
32	Purchase Debit Note (Inter-state Branch transfer) for Tr. Type 30.

- ✓ Illustrations of invoices under transaction codes 31 and 32 in purchase annexure for forms 231, 232, 233, 234 and 235 are as follows.

Transactionwise Purchase Details												
1500	100	1100	0	500	0	500	700	4400				
Taxable Value OR Value of Composition u/s 42(3),(3A)		Value of Inclusive of Tax Rs.	Value of Composition u/s 42(1), (2), (4) Rs.	Tax Free Purchases Rs.	Exempted Purchases u/s 41 & 8 Rs.	Labour Charges Rs.	Other Charges (Rs)	Gross Total (Rs.)	Action	Return Form Number	Transaction Code	Description of Transaction type
Net Rs.	TAX (If any) Rs.											
100.00	0.00	0.00	0.00	100.00	0.00	100.00	100.00	400.00		231	31	Purchase Good Return (Inter-state Branch transfer) for Tr. Type 30
100.00	0.00	0.00	0.00	100.00	0.00	100.00	100.00	400.00		232	31	Purchase Good Return (Inter-state Branch transfer) for Tr. Type 30
100.00	0.00	0.00	0.00	100.00	0.00	100.00	100.00	400.00		233	31	Purchase Good Return (Inter-state Branch transfer) for Tr. Type 30
100.00	0.00	0.00	0.00	100.00	0.00	100.00	100.00	400.00		234	31	Purchase Good Return (Inter-state Branch transfer) for Tr. Type 30
100.00	0.00	0.00	0.00	100.00	0.00	100.00	100.00	400.00		235	31	Purchase Good Return (Inter-state Branch transfer) for Tr. Type 30

Transactionwise Purchase Details												
1500	100	1100	0	500	0	500	700	4400				
Taxable Value OR Value of Composition u/s 42(3),(3A)		Value of Inclusive of Tax Rs.	Value of Composition u/s 42(1), (2), (4) Rs.	Tax Free Purchases Rs.	Exempted Purchases u/s 41 & 8 Rs.	Labour Charges Rs.	Other Charges (Rs)	Gross Total (Rs.)	Action	Return Form Number	Transaction Code	Description of Transaction type
Net Rs.	TAX (If any) Rs.											
100.00	0.00	0.00	0.00	100.00	0.00	100.00	100.00	400.00		231	32	Purchase Debit Note (Inter-state Branch transfer) for Tr. Type 30
100.00	0.00	0.00	0.00	100.00	0.00	100.00	100.00	400.00		232	32	Purchase Debit Note (Inter-state Branch transfer) for Tr. Type 30
100.00	0.00	0.00	0.00	100.00	0.00	100.00	100.00	400.00		233	32	Purchase Debit Note (Inter-state Branch transfer) for Tr. Type 30
100.00	0.00	0.00	0.00	100.00	0.00	100.00	100.00	400.00		234	32	Purchase Debit Note (Inter-state Branch transfer) for Tr. Type 30
100.00	0.00	0.00	0.00	100.00	0.00	100.00	100.00	400.00		235	32	Purchase Debit Note (Inter-state Branch transfer) for Tr. Type 30

 Shows blocked field, data shall not be validated.

4. Within State Branch Transfer/Consignment Transactions [35]-

- ✓ For the purposes of forms 231, 232, 233, 234 and 235 the transaction code in Purchases annexure for branch transfer/consignment within state is 35. Description for code is as follows-

Transaction Code	Description of Transaction
35	Within the State branch transfer

- ✓ Transaction code 35 is for Within State Branch Transfer/consignment sale.
- ✓ Illustrations of invoices under transaction code 35 in purchase annexure for forms 231, 232, 233, 234 and 235 are as follows.

Transactionwise Purchase Details												
1500	100	1100	0	500	0	500	700	4400				
Taxable Value OR Value of Composition u/s 42(3),(3A)		Value of Inclusive of Tax Rs.	Value of Composition u/s 42(1), (2), (4) Rs.	Tax Free Purchases Rs.	Exempted Purchases u/s 41 & 8 Rs.	Labour Charges Rs.	Other Charges (Rs)	Gross Total (Rs.)	Action	Return Form Number	Transaction Code	Description of Transaction type
Net Rs.	TAX (If any) Rs.											
100.00	0.00	0.00	0.00	100.00	0.00	100.00	100.00	400.00		231	35	Within the State Branch Transfer
100.00	0.00	0.00	0.00	100.00	0.00	100.00	100.00	400.00		232	35	Within the State Branch Transfer
100.00	0.00	0.00	0.00	100.00	0.00	100.00	100.00	400.00		233	35	Within the State Branch Transfer
100.00	0.00	0.00	0.00	100.00	0.00	100.00	100.00	400.00		234	35	Within the State Branch Transfer
100.00	0.00	0.00	0.00	100.00	0.00	100.00	100.00	400.00		235	35	Within the State Branch Transfer

 Shows blocked field, data shall not be validated.

Goods return [36] and debit notes [37] for branch transfer/consignment within state [35]-

- ✓ For the purposes of forms 231, 232, 233, 234 and 235 and transaction 35, the transaction codes in purchase annexure for goods return is 36 and for debit note (rate difference, discount) is 37. Description for codes is as follows-

Transaction Code	Description of Transaction
36	Purchase Goods Return (Within State Branch transfer) for Tr. Type 35.
37	Purchase Debit Note (Within State Branch transfer) for Tr. Type 35.

- ✓ Illustrations of invoices under transaction codes 36 and 37 in purchase annexure for forms 231, 232, 233, 234 and 235 are as follows.

Transactionwise Purchase Details												
1500	100	1100	0	500	0	500	700	4400				
Taxable Value OR Value of Composition u/s 42(3),(3A)		Value of Inclusive of Tax Rs.	Value of Composition u/s 42(1), (2), (4) Rs.	Tax Free Purchases Rs.	Exempted Purchases u/s 41 & 8 Rs.	Labour Charges Rs.	Other Charges (Rs)	Gross Total (Rs.)	Action	Return Form Number	Transaction Code	Description of Transaction type
Net Rs.	TAX (if any) Rs.											
100.00	0.00	0.00	0.00	100.00	0.00	100.00	100.00	400.00		231	36	Purchase Good Return (Within State Branch transfer) for Tr. Type 35
100.00	0.00	0.00	0.00	100.00	0.00	100.00	100.00	400.00		232	36	Purchase Good Return (Within State Branch transfer) for Tr. Type 35
100.00	0.00	0.00	0.00	100.00	0.00	100.00	100.00	400.00		233	36	Purchase Good Return (Within State Branch transfer) for Tr. Type 35
100.00	0.00	0.00	0.00	100.00	0.00	100.00	100.00	400.00		234	36	Purchase Good Return (Within State Branch transfer) for Tr. Type 35
100.00	0.00	0.00	0.00	100.00	0.00	100.00	100.00	400.00		235	36	Purchase Good Return (Within State Branch transfer) for Tr. Type 35

1500	100	1100	0	500	0	500	700	4400				
Taxable Value OR Value of Composition u/s 42(3),(3A)		Value of Inclusive of Tax Rs.	Value of Composition u/s 42(1), (2), (4) Rs.	Tax Free Purchases Rs.	Exempted Purchases u/s 41 & 8 Rs.	Labour Charges Rs.	Other Charges (Rs)	Gross Total (Rs.)	Action	Return Form Number	Transaction Code	Description of Transaction type
Net Rs.	TAX (if any) Rs.											
100.00	0.00	0.00	0.00	100.00	0.00	100.00	100.00	400.00		231	37	Purchase Debit Note (Within State Branch transfer) for Tr. Type 35
100.00	0.00	0.00	0.00	100.00	0.00	100.00	100.00	400.00		232	37	Purchase Debit Note (Within State Branch transfer) for Tr. Type 35
100.00	0.00	0.00	0.00	100.00	0.00	100.00	100.00	400.00		233	37	Purchase Debit Note (Within State Branch transfer) for Tr. Type 35
100.00	0.00	0.00	0.00	100.00	0.00	100.00	100.00	400.00		234	37	Purchase Debit Note (Within State Branch transfer) for Tr. Type 35
100.00	0.00	0.00	0.00	100.00	0.00	100.00	100.00	400.00		235	37	Purchase Debit Note (Within State Branch transfer) for Tr. Type 35

 Shows blocked field, data shall not be validated.

5. Inter-State Purchases against Form-C [40] -

- ✓ For the purposes of forms 231, 232, 233, 234 and 235 the transaction code in Purchases annexure for Inter-State Purchases against Form-C is 40. Description for code is as follows-

Transaction Code	Description of Transaction
40	Inter-State Purchases against Form-C

- ✓ Transaction code 40 is for Inter-State Purchases against Form-C.
- ✓ Illustrations of invoices under transaction code 40 in purchase annexure for forms 231, 232, 233, 234 and 235 are as follows.

Transactionwise Purchase Details												
1500	125	1625	0	500	500	500	700	5450				
Taxable Value OR Value of Composition u/s 42(3),(3A)		Value of Inclusive of Tax Rs.	Value of Composition u/s 42(1), (2), (4) Rs.	Tax Free Purchases Rs.	Exempted Purchases u/s 41 & 8 Rs.	Labour Charges Rs.	Other Charges (Rs)	Gross Total (Rs.)	Action	Return Form Number	Transaction Code	Description of Transaction type
Net Rs.	TAX (If any) Rs.											
100.00	5.00	105.00	0.00	100.00	100.00	100.00	100.00	610.00		231	40	Inter-State Purchases against Form-C
100.00	5.00	105.00	0.00	100.00	100.00	100.00	100.00	610.00		232	40	Inter-State Purchases against Form-C
100.00	5.00	105.00	0.00	100.00	100.00	100.00	100.00	610.00		233	40	Inter-State Purchases against Form-C
100.00	5.00	105.00	0.00	100.00	100.00	100.00	100.00	610.00		234	40	Inter-State Purchases against Form-C
100.00	5.00	105.00	0.00	100.00	100.00	100.00	100.00	610.00		235	40	Inter-State Purchases against Form-C

 Shows blocked field, data shall not be validated.

Goods return [41] and debit notes [42] for Inter-State Purchases against Form-C [40] -

- ✓ For the purposes of forms 231, 232, 233, 234 and 235 and transaction 40, the transaction codes in purchase annexure for goods return is 41 and for debit note (rate difference, discount) is 42. Description for codes is as follows-

Transaction Code	Description of Transaction
41	Purchase Goods Return (Interstate Purchases against Form-C) for Tr. Type 40.
42	Purchase Debit Note (Interstate Purchases against Form-C) for Tr. Type 40.

- ✓ Illustrations of invoices under transaction codes 41 and 42 in purchase annexure for forms 231, 232, 233, 234 and 235 are as follows.

Transactionwise Purchase Details												
1500	125	1625	0	500	500	500	700	5450				
Taxable Value OR Value of Composition u/s 42(3),(3A)		Value of Inclusive of Tax Rs.	Value of Composition u/s 42(1), (2), (4) Rs.	Tax Free Purchases Rs.	Exempted Purchases u/s 41 & 8 Rs.	Labour Charges Rs.	Other Charges (Rs)	Gross Total (Rs.)	Action	Return Form Number	Transaction Code	Description of Transaction type
Net Rs.	TAX (If any) Rs.											
100.00	5.00	105.00	0.00	100.00	100.00	100.00	100.00	610.00		231	41	Purchase Good Return (Inter state Purchases against Form-C) for Tr. Type 40
100.00	5.00	105.00	0.00	100.00	100.00	100.00	100.00	610.00		232	41	Purchase Good Return (Inter state Purchases against Form-C) for Tr. Type 40
100.00	5.00	105.00	0.00	100.00	100.00	100.00	100.00	610.00		233	41	Purchase Good Return (Inter state Purchases against Form-C) for Tr. Type 40
100.00	5.00	105.00	0.00	100.00	100.00	100.00	100.00	610.00		234	41	Purchase Good Return (Inter state Purchases against Form-C) for Tr. Type 40
100.00	5.00	105.00	0.00	100.00	100.00	100.00	100.00	610.00		235	41	Purchase Good Return (Inter state Purchases against Form-C) for Tr. Type 40

Transactionwise Purchase Details												
1500	125	1625	0	500	500	500	700	5450				
Taxable Value OR Value of Composition u/s 42(3),(3A)		Value of Inclusive of Tax Rs.	Value of Composition u/s 42(1), (2), (4) Rs.	Tax Free Purchases Rs.	Exempted Purchases u/s 41 & 8 Rs.	Labour Charges Rs.	Other Charges (Rs)	Gross Total (Rs.)	Action	Return Form Number	Transaction Code	Description of Transaction type
Net Rs.	TAX (If any) Rs.											
100.00	5.00	105.00	0.00	100.00	100.00	100.00	100.00	610.00		231	42	Purchase Debit Note (Inter state Purchases against Form-C) for Tr. Type 40
100.00	5.00	105.00	0.00	100.00	100.00	100.00	100.00	610.00		232	42	Purchase Debit Note (Inter state Purchases against Form-C) for Tr. Type 40
100.00	5.00	105.00	0.00	100.00	100.00	100.00	100.00	610.00		233	42	Purchase Debit Note (Inter state Purchases against Form-C) for Tr. Type 40
100.00	5.00	105.00	0.00	100.00	100.00	100.00	100.00	610.00		234	42	Purchase Debit Note (Inter state Purchases against Form-C) for Tr. Type 40
100.00	5.00	105.00	0.00	100.00	100.00	100.00	100.00	610.00		235	42	Purchase Debit Note (Inter state Purchases against Form-C) for Tr. Type 40

 Shows blocked field, data shall not be validated.

6. Within the State Purchases against Form-C (Purchase in transit u/s 6(2) of CST Act) [45] -

- ✓ For the purposes of forms 231, 232, 233, 234 and 235 the transaction code in Purchases annexure for within the State Purchases against Form-C (Purchase in transit u/s 6(2) of CST Act) is 45. Description for code is as follows-

Transaction Code	Description of Transaction
45	Within the State Purchases against Form-C (Purchase in transit u/s 6(2))

- ✓ Transaction code 45 is for within the State Purchases against Form-C (Purchase in transit u/s 6(2) of CST Act).
- ✓ Illustrations of invoices under transaction code 45 in purchase annexure for forms 231, 232, 233, 234 and 235 are as follows.

Transactionwise Purchase Details												
300	15	315	0	400	400	400	300	2130				
Taxable Value OR Value of Composition u/s 42(3),(3A)		Value of Inclusive of Tax Rs.	Value of Composition u/s 42(1), (2), (4) Rs.	Tax Free Purchases Rs.	Exempted Purchases u/s 41 & 8 Rs.	Labour Charges Rs.	Other Charges (Rs)	Gross Total (Rs.)	Action	Return Form Number	Transaction Code	Description of Transaction type
Net Rs.	TAX (if any) Rs.											
100.00	5.00	105.00	0.00	100.00	100.00	100.00	100.00	610.00		232	45	Within the State Purchases against Form-C (Purchase in transit u/s 6(2))
0.00	0.00	105.00	0.00	100.00	100.00	100.00	100.00	505.00		232	45	Within the State Purchases against Form-C (Purchase in transit u/s 6(2))
0.00	0.00	0.00	0.00	100.00	100.00	100.00	100.00	400.00		232	45	Within the State Purchases against Form-C (Purchase in transit u/s 6(2))
100.00	5.00	0.00	0.00	0.00	0.00	0.00	0.00	105.00		232	45	Within the State Purchases against Form-C (Purchase in transit u/s 6(2))
100.00	5.00	0.00	0.00	100.00	100.00	100.00	0.00	405.00		232	45	Within the State Purchases against Form-C (Purchase in transit u/s 6(2))
0.00	0.00	105.00		0.00	0.00	0.00	0.00	105.00		232	45	Within the State Purchases against Form-C (Purchase in transit u/s 6(2))

Shows blocked field, data shall not be validated.

Goods return [46] and debit notes [47] for within the State Purchases against Form-C (Purchase in transit u/s 6(2) of CST Act) [45] -

- ✓ For the purposes of forms 231, 232, 233, 234 and 235 and transaction 45, the transaction codes in purchase annexure for goods return is 46 and for debit note (rate difference, discount) is 47. Description for codes is as follows-

Transaction Code	Description of Transaction
46	Purchase Goods Return (within the State Purchases against Form-C (Purchase in transit u/s 6(2)) for Transaction Type 45.
47	Purchase Debit Note (within the State Purchases against Form-C (Purchase in transit u/s 6(2)) for Transaction Type 45.

- ✓ Illustrations of invoices under transaction codes 46 and 47 in purchase annexure for forms 231, 232, 233, 234 and 235 are as follows.

Transactionwise Purchase Details												
300	15	315	0	400	400	400	300	2130				
Taxable Value OR Value of Composition u/s 42(3),(3A)		Value of Inclusive of Tax Rs.	Value of Composition u/s 42(1), (2), (4) Rs.	Tax Free Purchases Rs.	Exempted Purchases u/s 41 & 8 Rs.	Labour Charges Rs.	Other Charges (Rs)	Gross Total (Rs.)	Action	Return Form Number	Transaction Code	Description of Transaction type
Net Rs.	TAX (if any) Rs.											
100.00	5.00	105.00	0.00	100.00	100.00	100.00	100.00	610.00		232	46	Purchase Good Return (Within State purchases against Form-C) for Tr. Type 45
0.00	0.00	105.00	0.00	100.00	100.00	100.00	100.00	505.00		232	46	Purchase Good Return (Within State purchases against Form-C) for Tr. Type 45
0.00	0.00	0.00	0.00	100.00	100.00	100.00	100.00	400.00		232	46	Purchase Good Return (Within State purchases against Form-C) for Tr. Type 45
100.00	5.00	0.00	0.00	0.00	0.00	0.00	0.00	105.00		232	46	Purchase Good Return (Within State purchases against Form-C) for Tr. Type 45
100.00	5.00	0.00	0.00	100.00	100.00	100.00	0.00	405.00		232	46	Purchase Good Return (Within State purchases against Form-C) for Tr. Type 45
0.00	0.00	105.00	0.00	0.00	0.00	0.00	0.00	105.00		232	46	Purchase Good Return (Within State purchases against Form-C) for Tr. Type 45

Transactionwise Purchase Details												
300	15	315	0	400	400	400	300	2130				
Taxable Value OR Value of Composition u/s 42(3),(3A)		Value of Inclusive of Tax Rs.	Value of Composition u/s 42(1), (2), (4) Rs.	Tax Free Purchases Rs.	Exempted Purchases u/s 41 & 8 Rs.	Labour Charges Rs.	Other Charges (Rs)	Gross Total (Rs.)	Action	Return Form Number	Transaction Code	Description of Transaction type
Net Rs.	TAX (if any) Rs.											
100.00	5.00	105.00	0.00	100.00	100.00	100.00	100.00	610.00		232	47	Purchase Debit Note (Within State Purchases against Form-C) for Tr. Type 45
0.00	0.00	105.00	0.00	100.00	100.00	100.00	100.00	505.00		232	47	Purchase Debit Note (Within State Purchases against Form-C) for Tr. Type 45
0.00	0.00	0.00	0.00	100.00	100.00	100.00	100.00	400.00		232	47	Purchase Debit Note (Within State Purchases against Form-C) for Tr. Type 45
100.00	5.00	0.00	0.00	0.00	0.00	0.00	0.00	105.00		232	47	Purchase Debit Note (Within State Purchases against Form-C) for Tr. Type 45
100.00	5.00	0.00	0.00	100.00	100.00	100.00	0.00	405.00		232	47	Purchase Debit Note (Within State Purchases against Form-C) for Tr. Type 45
0.00	0.00	105.00	0.00	0.00	0.00	0.00	0.00	105.00		232	47	Purchase Debit Note (Within State Purchases against Form-C) for Tr. Type 45

 Shows blocked field, data shall not be validated.

7. Inter-State Purchases against Form-H [50] -

- ✓ For the purposes of forms 231, 232, 233, 234 and 235 the transaction code in Purchases annexure for interstate Purchases against Form-H is 50. Description for code is as follows-

Transaction Code	Description of Transaction
50	Inter-State Purchases against Form-H

- ✓ Transaction code 50 is for interstate Purchases against Form-H.
- ✓ Illustrations of invoices under transaction code 50 in purchase annexure for forms 231, 232, 233, 234 and 235 are as follows.

Transactionwise Purchase Details												
1500	100	1100	0	500	500	500	700	4900				
Taxable Value OR Value of Composition u/s 42(3),(3A)		Value of Inclusive of Tax Rs.	Value of Composition u/s 42(1), (2), (4) Rs.	Tax Free Purchases Rs.	Exempted Purchases u/s 41 & 8 Rs.	Labour Charges Rs.	Other Charges (Rs)	Gross Total (Rs.)	Action	Return Form Number	Transaction Code	Description of Transaction type
Net Rs.	TAX (If any) Rs.											
100.00	0.00	0.00	0.00	100.00	100.00	100.00	100.00	500.00		231	50	Inter-State Purchases against Form-H
100.00	0.00	0.00	0.00	100.00	100.00	100.00	100.00	500.00		232	50	Inter-State Purchases against Form-H
100.00	0.00	0.00	0.00	100.00	100.00	100.00	100.00	500.00		233	50	Inter-State Purchases against Form-H
100.00	0.00	0.00	0.00	100.00	100.00	100.00	100.00	500.00		234	50	Inter-State Purchases against Form-H
100.00	0.00	0.00	0.00	100.00	100.00	100.00	100.00	500.00		235	50	Inter-State Purchases against Form-H

 Shows blocked field, data shall not be validated.

Goods return [51] and debit notes [52] for interstate Purchases against Form-H [50] -

- ✓ For the purposes of forms 231, 232, 233, 234 and 235 and transaction 50, the transaction codes in purchase annexure for goods return is 51 and for debit note (rate difference, discount) is 52. Description for codes is as follows-

Transaction Code	Description of Transaction
51	Purchase Goods Return (Inter State Purchases against Form-H) for Tr. Type 50.
52	Purchase Debit Note (Inter State Purchases against Form-H) for Tr. Type 50.

- ✓ Illustrations of invoices under transaction codes 51 and 52 in purchase annexure for forms 231, 232, 233, 234 and 235 are as follows.

Transactionwise Purchase Details												
1500	100	1100	0	500	500	500	700	4900				
Taxable Value OR Value of Composition u/s 42(3),(3A)		Value of Inclusive of Tax Rs.	Value of Composition u/s 42(1), (2), (4) Rs.	Tax Free Purchases Rs.	Exempted Purchases u/s 41 & 8 Rs.	Labour Charges Rs.	Other Charges (Rs)	Gross Total (Rs.)	Action	Return Form Number	Transaction Code	Description of Transaction type
Net Rs.	TAX (If any) Rs.											
100.00	0.00	0.00	0.00	100.00	100.00	100.00	100.00	500.00		231	51	Purchase Good Return (Inter State Purchases against Form-H) for Tr. Type 50
100.00	0.00	0.00	0.00	100.00	100.00	100.00	100.00	500.00		232	51	Purchase Good Return (Inter State Purchases against Form-H) for Tr. Type 50
100.00	0.00	0.00	0.00	100.00	100.00	100.00	100.00	500.00		233	51	Purchase Good Return (Inter State Purchases against Form-H) for Tr. Type 50
100.00	0.00	0.00	0.00	100.00	100.00	100.00	100.00	500.00		234	51	Purchase Good Return (Inter State Purchases against Form-H) for Tr. Type 50
100.00	0.00	0.00	0.00	100.00	100.00	100.00	100.00	500.00		235	51	Purchase Good Return (Inter State Purchases against Form-H) for Tr. Type 50

Transactionwise Purchase Details												
1500	100	1100	0	500	500	500	700	4900				
Taxable Value OR Value of Composition u/s 42(3),(3A)		Value of Inclusive of Tax Rs.	Value of Composition u/s 42(1), (2), (4) Rs.	Tax Free Purchases Rs.	Exempted Purchases u/s 41 & 8 Rs.	Labour Charges Rs.	Other Charges (Rs)	Gross Total (Rs.)	Action	Return Form Number	Transaction Code	Description of Transaction type
Net Rs.	TAX (If any) Rs.											
100.00	0.00	0.00	0.00	100.00	100.00	100.00	100.00	500.00		231	52	Purchase Debit Note (Inter State Purchases against Form-H) for Tr. Type 50
100.00	0.00	0.00	0.00	100.00	100.00	100.00	100.00	500.00		232	52	Purchase Debit Note (Inter State Purchases against Form-H) for Tr. Type 50
100.00	0.00	0.00	0.00	100.00	100.00	100.00	100.00	500.00		233	52	Purchase Debit Note (Inter State Purchases against Form-H) for Tr. Type 50
100.00	0.00	0.00	0.00	100.00	100.00	100.00	100.00	500.00		234	52	Purchase Debit Note (Inter State Purchases against Form-H) for Tr. Type 50
100.00	0.00	0.00	0.00	100.00	100.00	100.00	100.00	500.00		235	52	Purchase Debit Note (Inter State Purchases against Form-H) for Tr. Type 50

 Shows blocked field, data shall not be validated.

8. Within the State Purchases against H Form [55] -

- ✓ For the purposes of forms 231, 232, 233, 234 and 235 the transaction code in Purchase annexure for purchases within state against H Form is 55. Description for code is as follows-

Transaction Code	Description of Transaction
55	Within State Purchases against H Form

- ✓ Transaction code 55 is for within State Purchases against H Form.
- ✓ Illustrations of invoices under transaction code 55 in purchase annexure for forms 231, 232, 233, 234 and 235 are as follows.

Transactionwise Purchase Details												
1500	100	1100	0	500	500	500	700	4900				
Taxable Value OR Value of Composition u/s 42(3),(3A)		Value of Inclusive of Tax Rs.	Value of Composition u/s 42(1),(2),(4) Rs.	Tax Free Purchases Rs.	Exempted Purchases u/s 41 & 8 Rs.	Labour Charges Rs.	Other Charges (Rs)	Gross Total (Rs.)	Action	Return Form Number	Transaction Code	Description of Transaction type
Net Rs.	TAX (If any) Rs.											
100.00	0.00	0.00	0.00	100.00	100.00	100.00	100.00	500.00		231	55	Within the State Purchases against H Form
100.00	0.00	0.00	0.00	100.00	100.00	100.00	100.00	500.00		232	55	Within the State Purchases against H Form
100.00	0.00	0.00	0.00	100.00	100.00	100.00	100.00	500.00		233	55	Within the State Purchases against H Form
100.00	0.00	0.00	0.00	100.00	100.00	100.00	100.00	500.00		234	55	Within the State Purchases against H Form
100.00	0.00	0.00	0.00	100.00	100.00	100.00	100.00	500.00		235	55	Within the State Purchases against H Form

 Shows blocked field, data shall not be validated.

Goods return [56] and debit notes [57] for within State Purchases against Form H [55] -

- ✓ For the purposes of forms 231, 232, 233, 234 and 235 and transaction 55, the transaction codes in purchase annexure for goods return is 56 and for debit note (rate difference, discount) is 57. Description for codes is as follows-

Transaction Code	Description of Transaction
56	Purchase Goods Return (Within State Purchases against Form-H) for Tr. Type 55.
57	Purchase Debit Note (Within State Purchases against Form-H) for Tr. Type 55.

- ✓ Illustrations of invoices under transaction codes 56 and 57 in purchase annexure for forms 231, 232, 233, 234 and 235 are as follows.

Transactionwise Purchase Details												
1500	100	1100	0	500	500	500	700	4900				
Taxable Value OR Value of Composition u/s 42(3),(3A)		Value of Inclusive of Tax Rs.	Value of Composition u/s 42(1), (2), (4) Rs.	Tax Free Purchases Rs.	Exempted Purchases u/s 41 & 8 Rs.	Labour Charges Rs.	Other Charges (Rs)	Gross Total (Rs.)	Action	Return Form Number	Transaction Code	Description of Transaction type
Net Rs.	TAX (If any) Rs.											
100.00	0.00	0.00	0.00	100.00	100.00	100.00	100.00	500.00		231	56	Purchase Good Return (Within State Purchases against Form-H) for Tr. Type 55
100.00	0.00	0.00	0.00	100.00	100.00	100.00	100.00	500.00		232	56	Purchase Good Return (Within State Purchases against Form-H) for Tr. Type 55
100.00	0.00	0.00	0.00	100.00	100.00	100.00	100.00	500.00		233	56	Purchase Good Return (Within State Purchases against Form-H) for Tr. Type 55
100.00	0.00	0.00	0.00	100.00	100.00	100.00	100.00	500.00		234	56	Purchase Good Return (Within State Purchases against Form-H) for Tr. Type 55
100.00	0.00	0.00	0.00	100.00	100.00	100.00	100.00	500.00		235	56	Purchase Good Return (Within State Purchases against Form-H) for Tr. Type 55

Transactionwise Purchase Details												
1500	100	1100	0	500	500	500	700	4900				
Taxable Value OR Value of Composition u/s 42(3),(3A)		Value of Inclusive of Tax Rs.	Value of Composition u/s 42(1), (2), (4) Rs.	Tax Free Purchases Rs.	Exempted Purchases u/s 41 & 8 Rs.	Labour Charges Rs.	Other Charges (Rs)	Gross Total (Rs.)	Action	Return Form Number	Transaction Code	Description of Transaction type
Net Rs.	TAX (If any) Rs.											
100.00	0.00	0.00	0.00	100.00	100.00	100.00	100.00	500.00		231	57	Purchase Debit Note (Within State Purchases against Form-H) for Tr. Type 55
100.00	0.00	0.00	0.00	100.00	100.00	100.00	100.00	500.00		232	57	Purchase Debit Note (Within State Purchases against Form-H) for Tr. Type 55
100.00	0.00	0.00	0.00	100.00	100.00	100.00	100.00	500.00		233	57	Purchase Debit Note (Within State Purchases against Form-H) for Tr. Type 55
100.00	0.00	0.00	0.00	100.00	100.00	100.00	100.00	500.00		234	57	Purchase Debit Note (Within State Purchases against Form-H) for Tr. Type 55
100.00	0.00	0.00	0.00	100.00	100.00	100.00	100.00	500.00		235	57	Purchase Debit Note (Within State Purchases against Form-H) for Tr. Type 55

 Shows blocked field, data shall not be validated.

9. Purchase Transactions of Imports (Direct) [60]-

- ✓ For the purposes of forms 231, 232, 233, 234 and 235 the transaction code in Purchase annexure for Imports (Direct) is 60. Description for code is as follows-

Transaction Code	Description of Transaction
60	Imports (Direct)

- ✓ Transaction code 60 is for Imports (Direct).
- ✓ Illustrations of invoices under transaction code 60 in purchase annexure for forms 231, 232, 233, 234 and 235 are as follows.

Transactionwise Purchase Details												
1500	100	1100	0	0	0	0	700	3400				
Taxable Value OR Value of Composition u/s 42(3),(3A)		Value of Inclusive of Tax Rs.	Value of Composition u/s 42(1), (2), (4) Rs.	Tax Free Purchases Rs.	Exempted Purchases u/s 41 & 8 Rs.	Labour Charges Rs.	Other Charges (Rs)	Gross Total (Rs.)	Action	Return Form Number	Transaction Code	Description of Transaction type
Net Rs.	TAX (If any) Rs.											
100.00	0.00	0.00	0.00	0.00	0.00	0.00	100.00	200.00		231	60	Imports (Direct)
100.00	0.00	0.00	0.00	0.00	0.00	0.00	100.00	200.00		232	60	Imports (Direct)
100.00	0.00	0.00	0.00	0.00	0.00	0.00	100.00	200.00		233	60	Imports (Direct)
100.00	0.00	0.00	0.00	0.00	0.00	0.00	100.00	200.00		234	60	Imports (Direct)
100.00	0.00	0.00	0.00	0.00	0.00	0.00	100.00	200.00		235	60	Imports (Direct)

 Shows blocked field, data shall not be validated.

Goods return [61] and debit notes [62] for Imports (Direct) [60] -

- ✓ For the purposes of forms 231, 232, 233, 234 and 235 and transaction 60, the transaction codes in purchase annexure for goods return is 61 and for debit note (rate difference, discount) is 62. Description for codes is as follows-

Transaction Code	Description of Transaction
61	Purchase Goods Return (Direct Import) for Tr. Type 60.
62	Purchase Debit Note (Direct Import) for Tr. Type 60.

- ✓ Illustrations of invoices under transaction codes 61 and 62 in purchase annexure for forms 231, 232, 233, 234 and 235 are as follows.

Transactionwise Purchase Details												
1500	100	1100	0	0	0	0	700	3400				
Taxable Value OR Value of Composition u/s 42(3),(3A)		Value of Inclusive of Tax Rs.	Value of Composition u/s 42(1), (2), (4) Rs.	Tax Free Purchases Rs.	Exempted Purchases u/s 41 & 8 Rs.	Labour Charges Rs.	Other Charges (Rs)	Gross Total (Rs.)	Action	Return Form Number	Transaction Code	Description of Transaction type
Net Rs.	TAX (If any) Rs.											
100.00	0.00	0.00	0.00	0.00	0.00	0.00	100.00	200.00		231	61	Purchase Good Return (Direct Import) for Tr. Type 60
100.00	0.00	0.00	0.00	0.00	0.00	0.00	100.00	200.00		232	61	Purchase Good Return (Direct Import) for Tr. Type 60
100.00	0.00	0.00	0.00	0.00	0.00	0.00	100.00	200.00		233	61	Purchase Good Return (Direct Import) for Tr. Type 60
100.00	0.00	0.00	0.00	0.00	0.00	0.00	100.00	200.00		234	61	Purchase Good Return (Direct Import) for Tr. Type 60
100.00	0.00	0.00	0.00	0.00	0.00	0.00	100.00	200.00		235	61	Purchase Good Return (Direct Import) for Tr. Type 60

Transactionwise Purchase Details												
1500	100	1100	0	0	0	0	700	3400				
Taxable Value OR Value of Composition u/s 42(3),(3A)		Value of Inclusive of Tax Rs.	Value of Composition u/s 42(1), (2), (4) Rs.	Tax Free Purchases Rs.	Exempted Purchases u/s 41 & 8 Rs.	Labour Charges Rs.	Other Charges (Rs)	Gross Total (Rs.)	Action	Return Form Number	Transaction Code	Description of Transaction type
Net Rs.	TAX (If any) Rs.											
100.00	0.00	0.00	0.00	0.00	0.00	0.00	100.00	200.00		231	62	Purchase Debit Note (Direct Import) for Tr. Type 60
100.00	0.00	0.00	0.00	0.00	0.00	0.00	100.00	200.00		232	62	Purchase Debit Note (Direct Import) for Tr. Type 60
100.00	0.00	0.00	0.00	0.00	0.00	0.00	100.00	200.00		233	62	Purchase Debit Note (Direct Import) for Tr. Type 60
100.00	0.00	0.00	0.00	0.00	0.00	0.00	100.00	200.00		234	62	Purchase Debit Note (Direct Import) for Tr. Type 60
100.00	0.00	0.00	0.00	0.00	0.00	0.00	100.00	200.00		235	62	Purchase Debit Note (Direct Import) for Tr. Type 60

 Shows blocked field, data shall not be validated.

10. Purchase Transactions of Imports (High Seas) [65] -

- ✓ For the purposes of forms 231, 232, 233, 234 and 235 the transaction code in Purchases annexure for Imports (High Seas) is 65. Description for code is as follows-

Transaction Code	Description of Transaction
65	Imports (High Seas)

- ✓ Transaction code 65 is for Imports (High Seas).
- ✓ Illustrations of invoices under transaction code 65 in purchase annexure for forms 231, 232, 233, 234 and 235 are as follows.

Transactionwise Purchase Details												
1500	100	1100	0	0	0	0	700	3400				
Taxable Value OR Value of Composition u/s 42(3),(3A)		Value of Inclusive of Tax Rs.	Value of Composition u/s 42(1), (2), (4) Rs.	Tax Free Purchases Rs.	Exempted Purchases u/s 41 & 8 Rs.	Labour Charges Rs.	Other Charges (Rs)	Gross Total (Rs.)	Action	Return Form Number	Transaction Code	Description of Transaction type
Net Rs.	TAX (if any) Rs.											
100.00	0.00	0.00	0.00	0.00	0.00	0.00	100.00	200.00		231	65	Imports (High Seas)
100.00	0.00	0.00	0.00	0.00	0.00	0.00	100.00	200.00		232	65	Imports (High Seas)
100.00	0.00	0.00	0.00	0.00	0.00	0.00	100.00	200.00		233	65	Imports (High Seas)
100.00	0.00	0.00	0.00	0.00	0.00	0.00	100.00	200.00		234	65	Imports (High Seas)
100.00	0.00	0.00	0.00	0.00	0.00	0.00	100.00	200.00		235	65	Imports (High Seas)

 Shows blocked field, data shall not be validated.

Goods return [66] and debit notes [67] for Imports (High Seas) [65] -

- ✓ For the purposes of forms 231, 232, 233, 234 and 235 and transaction 65, the transaction codes in purchase annexure for goods return is 66 and for debit note (rate difference, discount) is 67. Description for codes is as follows-

Transaction Code	Description of Transaction
66	Purchase Goods Return Imports (High Seas) for Transaction Types 65.
67	Purchase Debit Note Imports (High Seas) for Transaction Types 65.

- ✓ Illustrations of invoices under transaction codes 66 and 67 in purchase annexure for forms 231, 232, 233, 234 and 235 are as follows.

Transactionwise Purchase Details												
1500	100	1100	0	0	0	0	700	3400				
Taxable Value OR Value of Composition u/s 42(3),(3A)		Value of Inclusive of Tax Rs.	Value of Composition u/s 42(1), (2), (4) Rs.	Tax Free Purchases Rs.	Exempted Purchases u/s 41 & 8 Rs.	Labour Charges Rs.	Other Charges (Rs)	Gross Total (Rs.)	Action	Return Form Number	Transaction Code	Description of Transaction type
Net Rs.	TAX (If any) Rs.											
100.00	0.00	0.00	0.00	0.00	0.00	0.00	100.00	200.00		231	66	Purchase Good Return (High Seas) for Tr. Type 65
100.00	0.00	0.00	0.00	0.00	0.00	0.00	100.00	200.00		232	66	Purchase Good Return (High Seas) for Tr. Type 65
100.00	0.00	0.00	0.00	0.00	0.00	0.00	100.00	200.00		233	66	Purchase Good Return (High Seas) for Tr. Type 65
100.00	0.00	0.00	0.00	0.00	0.00	0.00	100.00	200.00		234	66	Purchase Good Return (High Seas) for Tr. Type 65
100.00	0.00	0.00	0.00	0.00	0.00	0.00	100.00	200.00		235	66	Purchase Good Return (High Seas) for Tr. Type 65

Transactionwise Purchase Details												
1500	100	1100	0	0	0	0	700	3400				
Taxable Value OR Value of Composition u/s 42(3),(3A)		Value of Inclusive of Tax Rs.	Value of Composition u/s 42(1), (2), (4) Rs.	Tax Free Purchases Rs.	Exempted Purchases u/s 41 & 8 Rs.	Labour Charges Rs.	Other Charges (Rs)	Gross Total (Rs.)	Action	Return Form Number	Transaction Code	Description of Transaction type
Net Rs.	TAX (If any) Rs.											
100.00	0.00	0.00	0.00	0.00	0.00	0.00	100.00	200.00		231	67	Purchase Debit Note (High Seas) for Tr. Type 65
100.00	0.00	0.00	0.00	0.00	0.00	0.00	100.00	200.00		232	67	Purchase Debit Note (High Seas) for Tr. Type 65
100.00	0.00	0.00	0.00	0.00	0.00	0.00	100.00	200.00		233	67	Purchase Debit Note (High Seas) for Tr. Type 65
100.00	0.00	0.00	0.00	0.00	0.00	0.00	100.00	200.00		234	67	Purchase Debit Note (High Seas) for Tr. Type 65
100.00	0.00	0.00	0.00	0.00	0.00	0.00	100.00	200.00		235	67	Purchase Debit Note (High Seas) for Tr. Type 65

 Shows blocked field, data shall not be validated.

11. Interstate Purchases without Form/declaration [70] -

- ✓ For the purposes of forms 231, 232, 233, 234 and 235 the transaction code in Purchase annexure for interstate Purchases without Form is 70. Description for codes is as follows-

Transaction Code	Description of Transaction
70	Interstate Purchases without Form

- ✓ Transaction code 70 is for interstate purchases without Form/ declaration i.e. purchases at schedule rate.
- ✓ Illustrations of invoices under transaction code 70 in purchase annexure for forms 231, 232, 233, 234 and 235 are as follows.

Transactionwise Purchase Details												
1500	125	1625	0	500	500	500	700	5450				
Taxable Value OR Value of Composition u/s 42(3),(3A)		Value of Inclusive of Tax Rs.	Value of Composition u/s 42(1), (2), (4) Rs.	Tax Free Purchases Rs.	Exempted Purchases u/s 41 & 8 Rs.	Labour Charges Rs.	Other Charges (Rs)	Gross Total (Rs.)	Action	Return Form Number	Transaction Code	Description of Transaction type
Net Rs.	TAX (If any) Rs.											
100.00	5.00	105.00	0.00	100.00	100.00	100.00	100.00	610.00		231	70	Inter-State Purchases without Form
100.00	5.00	105.00	0.00	100.00	100.00	100.00	100.00	610.00		232	70	Inter-State Purchases without Form
100.00	5.00	105.00	0.00	100.00	100.00	100.00	100.00	610.00		233	70	Inter-State Purchases without Form
100.00	5.00	105.00	0.00	100.00	100.00	100.00	100.00	610.00		234	70	Inter-State Purchases without Form
100.00	5.00	105.00	0.00	100.00	100.00	100.00	100.00	610.00		235	70	Inter-State Purchases without Form

Shows blocked field, data shall not be validated.

Goods return [71] and debit notes [72] for interstate Purchases without Form [70] -

- ✓ For the purposes of forms 231, 232, 233, 234 and 235 and transaction 70, the transaction codes in purchase annexure for goods return is 71 and for debit note (rate difference, discount) is 72. Description for codes is as follows-

Transaction Code	Description of Transaction
71	Purchase Goods Return (Interstate Purchases without Form) for Transaction Types 70.
72	Purchase Debit Note (Interstate Purchases without Form) for Transaction Types 70.

- ✓ Illustrations of invoices under transaction codes 71 and 72 in purchase annexure for forms 231, 232, 233, 234 and 235 are as follows.

Transactionwise Purchase Details												
1500	125	1625	0	500	500	500	700	5450				
Taxable Value OR Value of Composition u/s 42(3),(3A)		Value of Inclusive of Tax Rs.	Value of Composition u/s 42(1), (2), (4) Rs.	Tax Free Purchases Rs.	Exempted Purchases u/s 41 & 8 Rs.	Labour Charges Rs.	Other Charges (Rs)	Gross Total (Rs.)	Action	Return Form Number	Transaction Code	Description of Transaction type
Net Rs.	TAX (If any) Rs.											
100.00	5.00	105.00	0.00	100.00	100.00	100.00	100.00	610.00		231	71	Purchase Good Return (Inter-State Purchases without Form) for Tr. Type 70
100.00	5.00	105.00	0.00	100.00	100.00	100.00	100.00	610.00		232	71	Purchase Good Return (Inter-State Purchases without Form) for Tr. Type 70
100.00	5.00	105.00	0.00	100.00	100.00	100.00	100.00	610.00		233	71	Purchase Good Return (Inter-State Purchases without Form) for Tr. Type 70
100.00	5.00	105.00	0.00	100.00	100.00	100.00	100.00	610.00		234	71	Purchase Good Return (Inter-State Purchases without Form) for Tr. Type 70
100.00	5.00	105.00	0.00	100.00	100.00	100.00	100.00	610.00		235	71	Purchase Good Return (Inter-State Purchases without Form) for Tr. Type 70

Transactionwise Purchase Details												
1500	125	1625	0	500	500	500	700	5450				
Taxable Value OR Value of Composition u/s 42(3),(3A)		Value of Inclusive of Tax Rs.	Value of Composition u/s 42(1), (2), (4) Rs.	Tax Free Purchases Rs.	Exempted Purchases u/s 41 & 8 Rs.	Labour Charges Rs.	Other Charges (Rs)	Gross Total (Rs.)	Action	Return Form Number	Transaction Code	Description of Transaction type
Net Rs.	TAX (If any) Rs.											
100.00	5.00	105.00	0.00	100.00	100.00	100.00	100.00	610.00		231	72	Purchase Debit Note (Inter-State Purchases without Form) for Tr. Type 70
100.00	5.00	105.00	0.00	100.00	100.00	100.00	100.00	610.00		232	72	Purchase Debit Note (Inter-State Purchases without Form) for Tr. Type 70
100.00	5.00	105.00	0.00	100.00	100.00	100.00	100.00	610.00		233	72	Purchase Debit Note (Inter-State Purchases without Form) for Tr. Type 70
100.00	5.00	105.00	0.00	100.00	100.00	100.00	100.00	610.00		234	72	Purchase Debit Note (Inter-State Purchases without Form) for Tr. Type 70
100.00	5.00	105.00	0.00	100.00	100.00	100.00	100.00	610.00		235	72	Purchase Debit Note (Inter-State Purchases without Form) for Tr. Type 70

 Shows blocked field, data shall not be validated.

12. Interstate Purchases against Form-I [75]-

- ✓ For the purposes of forms 231, 232, 233, 234 and 235 the transaction code in Purchase annexure for interstate purchases against Form-I is 75. Description for code is as follows-

Transaction Code	Description of Transaction
75	Interstate Purchases against Form-I

- ✓ Transaction code 75 is for Interstate Purchases against Form-I.
- ✓ Illustrations of invoices under transaction code 75 in purchase annexure for forms 231, 232, 233, 234 and 235 are as follows.

Transactionwise Purchase Details												
1500	100	1100	0	0	0	0	700	3400				
Taxable Value OR Value of Composition u/s 42(3),(3A)		Value of Inclusive of Tax Rs.	Value of Composition u/s 42(1), (2), (4) Rs.	Tax Free Purchases Rs.	Exempted Purchases u/s 41 & 8 Rs.	Labour Charges Rs.	Other Charges (Rs)	Gross Total (Rs.)	Action	Return Form Number	Transaction Code	Description of Transaction type
Net Rs.	TAX (If any) Rs.											
100.00	0.00	0.00	0.00	0.00	0.00	0.00	100.00	200.00		231	75	Inter-State Purchases against Form-I
100.00	0.00	0.00	0.00	0.00	0.00	0.00	100.00	200.00		232	75	Inter-State Purchases against Form-I
100.00	0.00	0.00	0.00	0.00	0.00	0.00	100.00	200.00		233	75	Inter-State Purchases against Form-I
100.00	0.00	0.00	0.00	0.00	0.00	0.00	100.00	200.00		234	75	Inter-State Purchases against Form-I
100.00	0.00	0.00	0.00	0.00	0.00	0.00	100.00	200.00		235	75	Inter-State Purchases against Form-I

 Shows blocked field, data shall not be validated.

Goods return [76] and debit notes [77] for Interstate Purchases against Form-I [75] -

- ✓ For the purposes of forms 231, 232, 233, 234 and 235 and transaction 75, the transaction codes in purchase annexure for goods return is 76 and for debit note (rate difference, discount) is 77. Description for codes is as follows-

Transaction Code	Description of Transaction
76	Purchase Goods Return (Interstate Purchases against Form-I) for Transaction Type 75.
77	Purchase Debit Note (Interstate Purchases against Form-I) for Transaction Type 75.

- ✓ Illustrations of invoices under transaction codes 76 and 77 in purchase annexure for forms 231, 232, 233, 234 and 235 are as follows.

Transactionwise Purchase Details												
1500	100	1100	0	0	0	0	700	3400				
Taxable Value OR Value of Composition u/s 42(3),(3A)		Value of Inclusive of Tax Rs.	Value of Composition u/s 42(1), (2), (4) Rs.	Tax Free Purchases Rs.	Exempted Purchases u/s 41 & 8 Rs.	Labour Charges Rs.	Other Charges (Rs)	Gross Total (Rs.)	Action	Return Form Number	Transaction Code	Description of Transaction type
Net Rs.	TAX (if any) Rs.											
100.00	0.00	0.00	0.00	0.00	0.00	0.00	100.00	200.00		231	76	Purchase Good Return (Inter-State Purchases against Form-I) for Tr. Type 75
100.00	0.00	0.00	0.00	0.00	0.00	0.00	100.00	200.00		232	76	Purchase Good Return (Inter-State Purchases against Form-I) for Tr. Type 75
100.00	0.00	0.00	0.00	0.00	0.00	0.00	100.00	200.00		233	76	Purchase Good Return (Inter-State Purchases against Form-I) for Tr. Type 75
100.00	0.00	0.00	0.00	0.00	0.00	0.00	100.00	200.00		234	76	Purchase Good Return (Inter-State Purchases against Form-I) for Tr. Type 75
100.00	0.00	0.00	0.00	0.00	0.00	0.00	100.00	200.00		235	76	Purchase Good Return (Inter-State Purchases against Form-I) for Tr. Type 75

Transactionwise Purchase Details												
1500	100	1100	0	0	0	0	700	3400				
Taxable Value OR Value of Composition u/s 42(3),(3A)		Value of Inclusive of Tax Rs.	Value of Composition u/s 42(1), (2), (4) Rs.	Tax Free Purchases Rs.	Exempted Purchases u/s 41 & 8 Rs.	Labour Charges Rs.	Other Charges (Rs)	Gross Total (Rs.)	Action	Return Form Number	Transaction Code	Description of Transaction type
Net Rs.	TAX (if any) Rs.											
100.00	0.00	0.00	0.00	0.00	0.00	0.00	100.00	200.00		231	77	Purchase Debit Note (Inter-State Purchases against Form-I) for Tr. Type 75
100.00	0.00	0.00	0.00	0.00	0.00	0.00	100.00	200.00		232	77	Purchase Debit Note (Inter-State Purchases against Form-I) for Tr. Type 75
100.00	0.00	0.00	0.00	0.00	0.00	0.00	100.00	200.00		233	77	Purchase Debit Note (Inter-State Purchases against Form-I) for Tr. Type 75
100.00	0.00	0.00	0.00	0.00	0.00	0.00	100.00	200.00		234	77	Purchase Debit Note (Inter-State Purchases against Form-I) for Tr. Type 75
100.00	0.00	0.00	0.00	0.00	0.00	0.00	100.00	200.00		235	77	Purchase Debit Note (Inter-State Purchases against Form-I) for Tr. Type 75

 Shows blocked field, data shall not be validated.

13. Deduction u/s 3(2) (Turnover of purchases before crossing threshold limit) [80] -

- ✓ For the purposes of forms 231, 232, 233, 234 and 235 the transaction code in Purchase annexure for Deduction u/s 3(2) (Turnover of purchases before crossing threshold limit for newly registered dealer) is 80. Description for code is as follows-

Transaction Code	Description of Transaction
80	Deduction u/s 3(2)

- ✓ Transaction code 80 is for Deduction u/s 3(2) (Turnover of purchases before crossing threshold limit).
- ✓ Illustrations of invoices under transaction code 80 in purchase annexure for forms 231, 232, 233, 234 and 235 are as follows.

Transactionwise Purchase Details												
1500	125	1625	500	500	500	500	700	5950				
Taxable Value OR Value of Composition u/s 42(3),(3A)	Value of Inclusive of Tax Rs.	Value of Composition u/s 42(1), (2), (4) Rs.	Tax Free Purchases Rs.	Exempted Purchases u/s 41 & 8 Rs.	Labour Charges Rs.	Other Charges (Rs)	Gross Total (Rs.)	Action	Return Form Number	Transaction Code	Description of Transaction type	
												Net Rs.
100.00	5.00	105.00	100.00	100.00	100.00	100.00	710.00		231	80	Deduction u/s 3(2)	
100.00	5.00	105.00	100.00	100.00	100.00	100.00	710.00		232	80	Deduction u/s 3(2)	
100.00	5.00	105.00	100.00	100.00	100.00	100.00	710.00		233	80	Deduction u/s 3(2)	
100.00	5.00	105.00	100.00	100.00	100.00	100.00	710.00		234	80	Deduction u/s 3(2)	
100.00	5.00	105.00	100.00	100.00	100.00	100.00	710.00		235	80	Deduction u/s 3(2)	

 Shows blocked field, data shall not be validated.

Goods return [90] and debit notes [95] for Deduction u/s 3(2) [80] -

- ✓ For the purposes of forms 231, 232, 233, 234 and 235 and transaction 80, the transaction codes in purchase annexure for goods return is 90 and for debit note (rate difference, discount) is 95. Description for codes is as follows-

Transaction Code	Description of Transaction
90	Purchase Goods Return for Transaction Types 80.
95	Purchase Debit Note for Transaction Types 80.

- ✓ Goods return [90] or debit note claim [95] against deduction u/s 3(2) [80] is not admissible in the first return of registered period.
- ✓ Illustrations of invoices under transaction codes 90 and 95 in purchase annexure for forms 231, 232, 233, 234 and 235 are as follows.

Transactionwise Purchase Details												
1500	125	1625	500	500	500	500	700	5950				
Taxable Value OR Value of Composition u/s 42(3),(3A)		Value of Inclusive of Tax Rs.	Value of Composition u/s 42(1), (2), (4) Rs.	Tax Free Purchases Rs.	Exempted Purchases u/s 41 & 8 Rs.	Labour Charges Rs.	Other Charges (Rs)	Gross Total (Rs.)	Action	Return Form Number	Transaction Code	Description of Transaction type
Net Rs.	TAX (If any) Rs.											
100.00	5.00	105.00	100.00	100.00	100.00	100.00	100.00	710.00		231	90	Purchase Good Return for Tr. Type 10, 15, 80
100.00	5.00	105.00	100.00	100.00	100.00	100.00	100.00	710.00		232	90	Purchase Good Return for Tr. Type 10, 15, 80
100.00	5.00	105.00	100.00	100.00	100.00	100.00	100.00	710.00		233	90	Purchase Good Return for Tr. Type 10, 15, 80
100.00	5.00	105.00	100.00	100.00	100.00	100.00	100.00	710.00		234	90	Purchase Good Return for Tr. Type 10, 15, 80
100.00	5.00	105.00	100.00	100.00	100.00	100.00	100.00	710.00		235	90	Purchase Good Return for Tr. Type 10, 15, 80

Transactionwise Purchase Details												
1500	125	1625	500	500	500	500	700	5950				
Taxable Value OR Value of Composition u/s 42(3),(3A)		Value of Inclusive of Tax Rs.	Value of Composition u/s 42(1), (2), (4) Rs.	Tax Free Purchases Rs.	Exempted Purchases u/s 41 & 8 Rs.	Labour Charges Rs.	Other Charges (Rs)	Gross Total (Rs.)	Action	Return Form Number	Transaction Code	Description of Transaction type
Net Rs.	TAX (If any) Rs.											
100.00	5.00	105.00	100.00	100.00	100.00	100.00	100.00	710.00		231	95	Purchase Debit Note for Tr. Type 10, 15, 80
100.00	5.00	105.00	100.00	100.00	100.00	100.00	100.00	710.00		232	95	Purchase Debit Note for Tr. Type 10, 15, 80
100.00	5.00	105.00	100.00	100.00	100.00	100.00	100.00	710.00		233	95	Purchase Debit Note for Tr. Type 10, 15, 80
100.00	5.00	105.00	100.00	100.00	100.00	100.00	100.00	710.00		234	95	Purchase Debit Note for Tr. Type 10, 15, 80
100.00	5.00	105.00	100.00	100.00	100.00	100.00	100.00	710.00		235	95	Purchase Debit Note for Tr. Type 10, 15, 80

 Shows blocked field, data shall not be validated.

SUMMARY OF TRANSACTION CODES FOR PURCHASE ANNEXURE

TRANSACTION CODES AND ITS DISCRPTION TO BE USED IN PURCHASE ANNEXURE FOR ALL RETURN FORMS					
Transaction Codes for Purchases		Transaction Code of Goods Return in relation with Main Transaction Code		Transaction Code of Rate Difference/ Discount in relation with Main Transaction Code	
Transaction Code	Description of Transaction type	Transaction Code	Description of Transaction type	Transaction Code	Description of Transaction type
10	Within the State Purchases from RD	90	Purchase Good Return for Transaction Type 10, 15, 80	95	Purchase Debit Note for Transaction Type 10, 15, 80
15	Within the State Purchases from RD (Capital Asset)	90	Purchase Good Return for Transaction Type 10, 15, 80	95	Purchase Debit Note for Transaction Type 10, 15, 80
20	Within the State URD Purchases/ Labour charges	91	Purchase Good Return (Within the State URD) for Transaction Type 20	96	Purchase Debit Note (Within the State URD) for Transaction Type 20
30	Inter-State Branch Transfer	31	Purchase Good Return (Inter-state Branch transfer) for Transaction Type 30	32	Purchase Debit Note (Inter-state Branch transfer) for Transaction Type 30
35	Within the State Branch Transfer	36	Purchase Good Return (Within State Branch transfer) for Transaction Type 35	37	Purchase Debit Note (Within State Branch transfer) for Transaction Type 35
40	Inter-State Purchases against Form-C	41	Purchase Good Return (Interstate Purchases against Form-C) for Transaction Type 40	42	Purchase Debit Note (Interstate Purchases against Form-C) for Transaction Type 40
45	Within the State Purchases against Form-C (Purchase in transit u/s 6(2))	46	Purchase Good Return (Within State purchases against Form-C) for Transaction Type 45	47	Purchase Debit Note (Within State Purchases against Form-C) for Transaction Type 45

SUMMARY OF TRANSACTION CODES FOR PURCHASE ANNEXURE

TRANSACTION CODES AND ITS DISCRPTION TO BE USED IN PURCHASE ANNEXURE FOR ALL RETURN FORMS					
Transaction Codes for Purchases		Transaction Code of Goods Return in relation with Main Transaction Code		Transaction Code of Rate Difference/ Discount in relation with Main Transaction Code	
Transaction Code	Description of Transaction type	Transaction Code	Description of Transaction type	Transaction Code	Description of Transaction type
50	Inter-State Purchases against Form-H	51	Purchase Good Return (Inter State Purchases against Form-H) for Transaction Type 50	52	Purchase Debit Note (Inter State Purchases against Form-H) for Transaction Type 50
55	Within the State Purchases against H Form	56	Purchase Good Return (Within State Purchases against Form-H) for Transaction Type 55	57	Purchase Debit Note (Within State Purchases against Form-H) for Transaction Type 55
60	Imports (Direct)	61	Purchase Good Return (Direct Import) for Transaction Type 60	62	Purchase Debit Note (Direct Import) for Transaction Type 60
65	Imports (High Seas)	66	Purchase Good Return (High Seas) for Transaction Type 65	67	Purchase Debit Note (High Seas) for Transaction Type 65
70	Inter-State Purchases without Form	71	Purchase Good Return (Inter-State Purchases without Form) for Transaction Type 70	72	Purchase Debit Note (Inter-State Purchases without Form) for Transaction Type 70
75	Inter-State Purchases against Form-I	76	Purchase Good Return (Inter-State Purchases against Form-I) for Transaction Type 75	77	Purchase Debit Note (Inter-State Purchases against Form-I) for Transaction Type 75
80	Deduction u/s 3(2)	90	Purchase Good Return for Transaction Type 10, 15, 80	95	Purchase Debit Note for Transaction Type 10, 15, 80

VALIDATE & PREVIEW RETURN

STEP 4: Validate and Preview Return

After filling up the sales and purchase annexure, please go to validate sheet



In validate sheet, press validate and preview button.

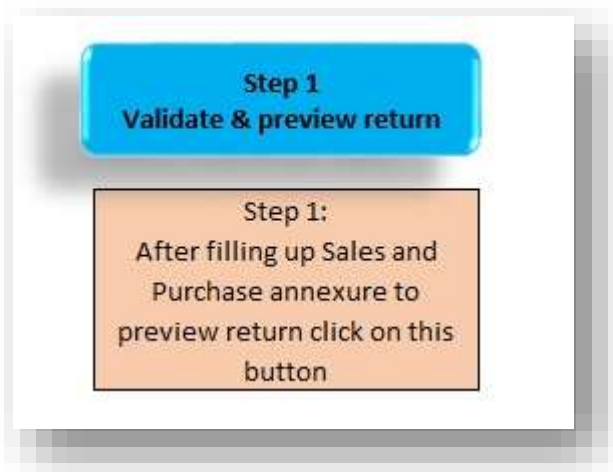

STEP 5: Manual Input in Preview Return

STEP 6: Validate and create file for upload

After manual input in preview return, to create file for uploading, in validate sheet, press create file for uploading button.

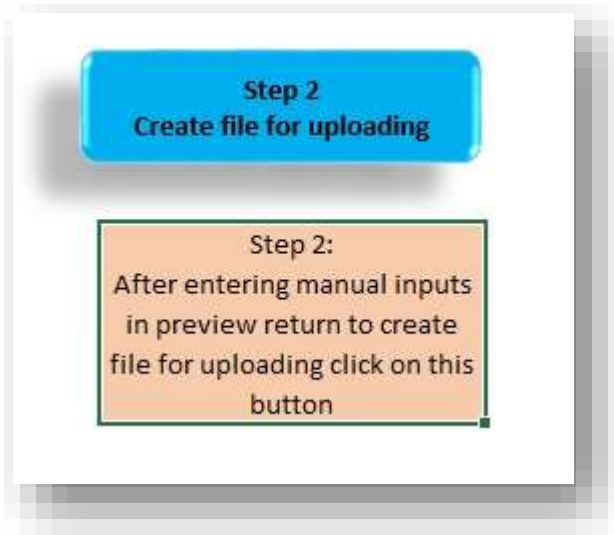

The txt file shall be created on desktop by TIN, form number, period and return type.

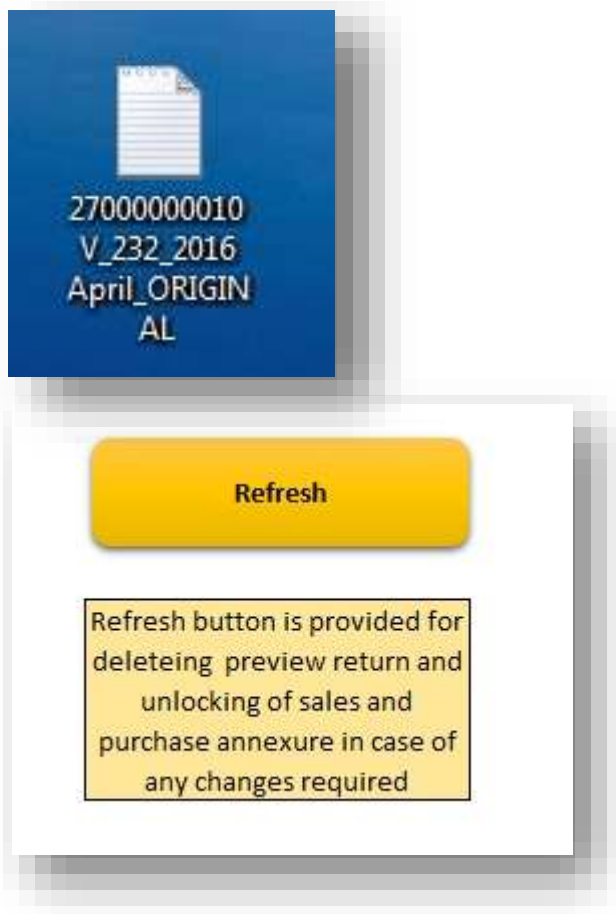

In case of any query, please contact Nodal
Officer or Help Desk

Help Desk Number: - 1800 225 900